



**NOTIFICATION TO ATTEND MEETING OF THE CENTRAL AREA COMMITTEE
TO BE HELD IN THE COUNCIL CHAMBER, CITY HALL, DAME STREET, DUBLIN 2.,
ON TUESDAY, 10 JANUARY 2017 AT 10.00 AM**

AGENDA

TUESDAY, 10 JANUARY 2017

		PAGE
1	Minutes of the Central Area Committee meeting held on 13th December, 2016	1 - 4
2	Questions to the Area Manager	5 - 8
3	With reference to a presentation on the proposed Liffey Cycle Route	
4	With reference to the proposed grant of a further licence of Units G05 - G07 of the Markets Area Community Resource Organisation (MACRO) Building, Green Street/North King Street, Dublin 7.	9 - 12
5	With reference to the proposed grant of a further licence of Unit G04 of the Markets Area Community Resource Organisation (MACRO) Building, No. 1 Green Street, Dublin 7.	13 - 16
6	With reference to the disposal of a plot of land to the rear of 1 Orchard Road, Drumcondra, Dublin 3 to Mary Cass as LPR of Patrick Cass (deceased).	17 - 18
7	With reference to a Naming and Numbering Proposal for a Development at 49a-51 Arbour Hill, Dublin 7	19 - 20
8	With reference to the minutes of the Traffic Advisory Group held on 20th December 2016	21 - 44
9	With reference to Updates on the following: Environmental Services Unit, North and East Inner City Housing Issues, North East Inner City Ministerial Task Force, Grangegorman Development, Central Area Age Friendly and Central Area Sports Report	45 - 62
10	With reference to Motions to the Central Area Committee	63 - 64



MINUTES OF THE CENTRAL AREA COMMITTEE MEETING

HELD ON TUESDAY, 13 DECEMBER 2016

- 1 Minutes of the Central Area Committee meeting held on 8th November, 2016
ORDER: Agreed.
- 2 Questions to the Area Manager
ORDER: Noted.
- 3 With reference to a presentation on the Pride of Place Awards
ORDER: Presentation noted.
- 4 With reference to the proposed grant of a three year licence of part of Ballybough Community Centre, Ballybough Road, Dublin 1 to the Larkin Unemployed Centre Limited.
ORDER: Agreed. Recommend to City Council.
- 5 With reference to the proposed grant of a further licence of part of the Ground Floor of the Markets Area Community Resource Organisation (MACRO) Building, Green Street/North King Street, Dublin 7 to MACRO Building Management Limited.
ORDER: Agreed. Recommend to City Council.
- 6 With reference to the proposed grant of a further licence of Unit F14 of the Markets Area Community Resource Organisation (MACRO) Building, Green Street/North King Street, Dublin 7 to North West Inner City Training & Development Project Limited.
ORDER: Agreed. Recommend to City Council.
- 7 With reference to the proposed grant of a further 3 year licence of the premises at 117-119 North King Street, Dublin 7 to the North West Inner City Network Limited.
ORDER: Agreed. Recommend to City Council.
- 8 With reference to the proposed grant of a further licence of Units F02-F10, F11 and F13 of the Markets Area Community Resource Organisation (MACRO) Building, Green Street/North King Street, Dublin 7 to Pitter Patter Community

Creche & Pre-School Limited.

ORDER: Agreed. Recommend to City Council.

- 9 With reference to the proposed grant of a further licence of Units S06 - S10 of the Markets Area Community Resource Organisation (MACRO) Building, Green Street/North King Street, Dublin 7 to Snug Counselling & Information Service Limited.

ORDER: Agreed. Recommend to City Council.

- 10 With reference to the proposed grant of a further licence of land for a community garden at the rear of Summer Street North / Sean O'Casey Avenue, Dublin 1.

ORDER: Agreed. Recommend to City Council.

- 11 With reference to the status report and minutes of the Traffic Advisory Group held on 29th November, 2016

ORDER: Reports noted. Member requested that a report on the Grangegorman Area Traffic Plan be brought to the next meeting. Traffic Engineer to look at the possibility of coordinating the date of the Tag meeting with the date of the Area Committee meeting.

- 12 With reference to Naming and Numbering Proposal for a Development at 49a-51 Arbour Hill, Dublin 7

ORDER: Item deferred until next month. Members requested a copy of the schedule of works and that the dwelling units facing onto Montpelier Hill be given a Montpelier Hill address (perhaps 68, 69, 70 Montpelier Hill) to avoid confusion.

- 13 With reference to a discussion on Waste Collection Services in the Central Area

ORDER: Discussion noted.

- 14 With reference to a nomination from the Central Area Committee members to the Phibsborough Local Environment Improvement Plan Implementation Group

ORDER: Councillor Ray McAdam was nominated to the Phibsborough Local Environment Improvement Plan Implementation Group

- 15 With reference to Updates on the following : Environmental Services Unit, North and East Inner City Housing Issues, North East Inner City Ministerial Task Force, Grangegorman Development, Central Area Age Friendly, Community Development Report and Central Area Reports

ORDER: Reports noted. Councillors requested that the Planning Department are invited to the February meeting to discuss student accommodation in the Central Area. They also requested that a presentation on the Liffey Cycle Route be brought to the next meeting.

- 16 With reference to Motions to the Central Area Committee

ORDER: Agreed except Motion 13 in the Name of Councillor Eilis Ryan which was deferred.

Cllr Ciaran Cuffe
Chairperson
Tuesday, 13 December 2016

Attendance:

Members:

Janice Boylan
Gaye Fagan
Nial Ring

Members:

Christy Burke
Gary Gannon

Members:

Ciaran Cuffe
Ray McAdam

Apologies:

_Cllr. Eilis Ryan

Non-Members:

Cllr. Mannix Flynn

Q1 Councillor Christy Burke

To ask the Chief Executive (details supplied)

Q2 Councillor Christy Burke

To ask the Chief Executive (details supplied)

Q3 Councillor Christy Burke

To ask the Chief Executive (details supplied)

Q4 Councillor Christy Burke

To ask the Chief Executive (details supplied)

Q5 Councillor Christy Burke

To ask the Chief Executive (details supplied)

Q6 Councillor Christy Burke

To ask the Chief Executive (details supplied)

Q7 Councillor Christy Burke

To ask the Chief Executive (details supplied)

Q8 Councillor Christy Burke

To ask the Chief Executive (details supplied)

Q9 Councillor Christy Burke

To ask the Chief Executive (details supplied)

Q10 Councillor Gaye Fagan

To ask the Chief Executive (details supplied)

Q11 Councillor Gaye Fagan

To ask the Chief Executive (details supplied)

Q12 Councillor Gaye Fagan

To ask the Chief Executive (details supplied)

Q13 Councillor Gaye Fagan

To ask the Chief Executive (details supplied)

Q14 Councillor Gaye Fagan

To ask the Chief Executive (details supplied)

- Q15** **Councillor Ciaran Cuffe**
To ask the Chief Executive (details supplied)
- Q16** **Councillor Ciaran Cuffe**
To ask the Chief Executive (details supplied)
- Q17** **Councillor Ciaran Cuffe**
To ask the Chief Executive (details supplied)
- Q18** **Councillor Ciaran Cuffe**
To ask the Chief Executive (details supplied)
- Q19** **Councillor Ciaran Cuffe**
To ask the Chief Executive (details supplied)
- Q20** **Councillor Ciaran Cuffe**
To ask the Chief Executive (details supplied)
- Q21** **Councillor Ciaran Cuffe**
To ask the Chief Executive (details supplied)
- Q22** **Councillor Ciaran Cuffe**
To ask the Chief Executive (details supplied)
- Q23** **Councillor Ciaran Cuffe**
To ask the Chief Executive (details supplied)
- Q24** **Councillor Ciaran Cuffe**
To ask the Chief Executive (details supplied)
- Q25** **Councillor Nial Ring**
To ask the Chief Executive (details supplied)
- Q26** **Councillor Nial Ring**
To ask the Chief Executive (details supplied)
- Q27** **Councillor Nial Ring**
To ask the Chief Executive (details supplied)
- Q28** **Councillor Nial Ring**
To ask the Chief Executive (details supplied)
- Q29** **Councillor Nial Ring**
To ask the Chief Executive (details supplied)

- Q30** **Councillor Nial Ring**
To ask the Chief Executive (details supplied)
- Q31** **Councillor Nial Ring**
To ask the Chief Executive (details supplied)
- Q32** **Councillor Nial Ring**
To ask the Chief Executive (details supplied)
- Q33** **Councillor Nial Ring**
To ask the Chief Executive (details supplied)
- Q34** **Councillor Nial Ring**
To ask the Chief Executive (details supplied)
- Q35** **Councillor Ray McAdam**
To ask the Chief Executive (details supplied)
- Q36** **Councillor Ray McAdam**
To ask the Chief Executive (details supplied)
- Q37** **Councillor Ray McAdam**
To ask the Chief Executive (details supplied)
- Q38** **Councillor Ray McAdam**
To ask the Chief Executive (details supplied)
- Q39** **Councillor Ray McAdam**
To ask the Chief Executive (details supplied)
- Q40** **Councillor Ray McAdam**
To ask the Chief Executive (details supplied)
- Q41** **Councillor Ray McAdam**
To ask the Chief Executive (details supplied)

22nd December, 2016

**To the Chairperson and Members
of the Central Area Committee**

With reference to the proposed grant of a further licence of Units G05 – G07 of the Markets Area Community Resource Organisation (MACRO) Building, Green Street/North King Street, Dublin 7.

By way of licence dated 16th April 2015, Units G05-G07 of the Markets Area Community Resource Organisation (MACRO) Building, Green Street/North King Street, Dublin 7 which said Units are more particularly shown coloured pink on Map Index No. SM2010-0367-001 was let under licence by Dublin City Council to Dublin City Centre Citizens Information Service Limited for a period of 2 years from 1st February 2015. This licence is due to expire on 31st January 2017.

It is proposed to grant a further two year licence to Dublin City Centre Citizens Information Service subject to the following terms and conditions:

1. The proposed licence shall be for the period of 2 years from 1st February 2017 subject to a licence fee of €1.00 if demanded.
2. The proposed licensed area is Units G05-G07 and is more particularly shown coloured pink on Map Index No. SM2010-0367-001.
3. The proposed licence shall be subject to a contribution fee of €12,240 per annum in respect of the cost of managing the building payable quarterly in advance directly to MACRO Building Management CLG who manage the Centre on the Council's behalf.
4. The licensee shall sign a deed of renunciation in respect of the licensed area.
5. The licensee shall be entitled to use the licensed area during the opening hours of the Markets Area Community Resource Organisation building which are 8.00 am to 10.00pm daily.
6. The licence can be terminated by either party on giving the other one months notice in writing.
7. The licensee shall be responsible for all outgoings including waste charges and any water charges which may become payable.
8. The licensee shall keep its part of the premises in good condition and repair during the term of the licence.
9. The licensee shall obtain public liability insurance (€6.5 million) and employer's liability insurance (€13 million) if they have employees and shall indemnify the City Council against any and all claims for compensation, which may arise from their use of their used of the property.

10. On termination of the licence, the licensee shall be responsible for the removal of all their materials from the premises.
11. The licensee shall not assign, sub-let alienate or part with possession of the subject property.
12. The licensee shall not erect any signage on the external or internal walls of the subject property without the prior consent of the Council.
13. The licence will be subject to any terms and conditions deemed appropriate by the Law Agent
14. Each party shall be responsible for its own legal costs.

Paul Clegg.

Executive Manager.

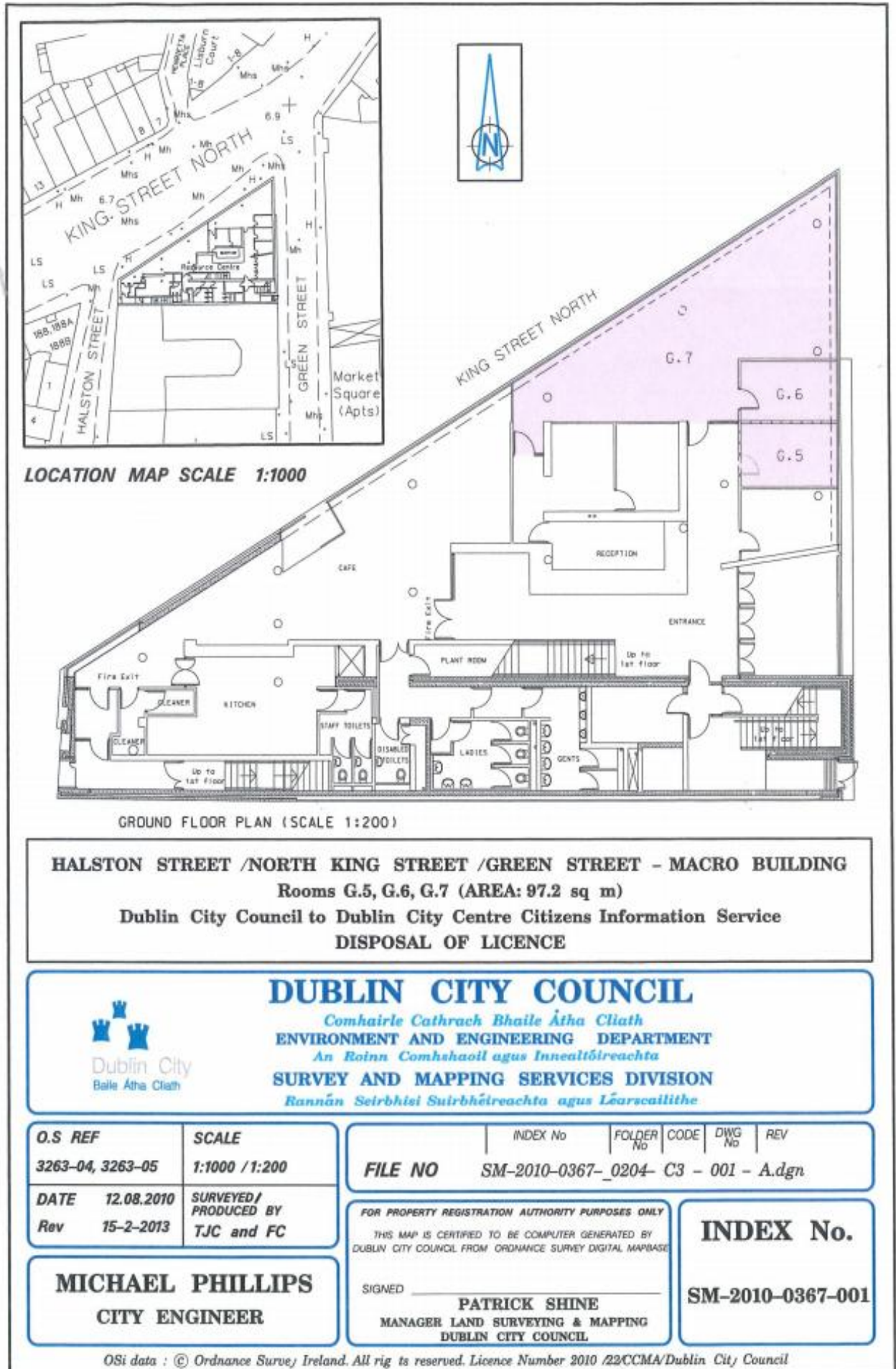

12th December 2016

**To the Chairperson and Members
of the Central Area Committee**

With reference to the proposed grant of a further licence of Unit G04 of the Markets Area Community Resource Organisation (MACRO) Building, No. 1 Green Street, Dublin 7.

By way of Agreement dated 2nd April 2015, Unit G04 of the Markets Area Community Resource Organisation (MACRO) Building, No. 1 Green Street, Dublin 7 which is delineated on Map Index No. SM2010-0367-002 was let under licence by Dublin City Council to Georges Hill School & Community Project Limited for a period of 2 years commencing on 1st February 2015. This licence is due to expire on 31st January 2017.

It is proposed to grant a further two year licence to Georges Hill School & Community Project Limited subject to the following terms and conditions:

1. The proposed licence shall be for the period of 2 years from 1st February 2017 subject to a licence fee of €1.00 if demanded.
2. The proposed licensed area is known as Unit G04, and is more particularly shown coloured pink on Map Index No. SM2010-0367-002.
3. The proposed licence shall be subject to a contribution fee of €1,331.12 per annum in respect of the cost of managing the building payable quarterly in advance directly to MACRO Building Management Limited who manage the premises on behalf of the Council.
4. The licensee shall sign a deed of renunciation in respect of the licensed area.
5. The licensee shall be entitled to use the licensed area during the opening hours of the Markets Area Community Resource Organisation building which are 8.00 am to 10.00pm daily.
6. The licence can be terminated by either party on giving the other one months notice in writing.
7. The licensee shall be responsible for all outgoing including waste charges and any water charges which may become payable.
8. The licensee shall keep its part of the premises in good condition and repair during the term of the licence.
9. The licensee shall obtain public liability insurance (€6.5 million) and employer's liability insurance (€13 million) if they have employees and shall indemnify the City Council against any and all claims for compensation, which may arise from their use of their used of the property.
10. On termination of the licence, the licensee shall be responsible for the removal of all their materials from the premises.

11. The licensee shall not assign, sub-let alienate or part with possession of the subject property.
12. The licensee shall not erect any signage on the external or internal walls of the subject property without the prior consent of the Council.
13. The licence will be subject to any other terms and conditions deemed appropriate by the Law Agent in Agreements of this type.
14. Each party shall be responsible for its own legal costs.

Paul Clegg.

Executive Manager.

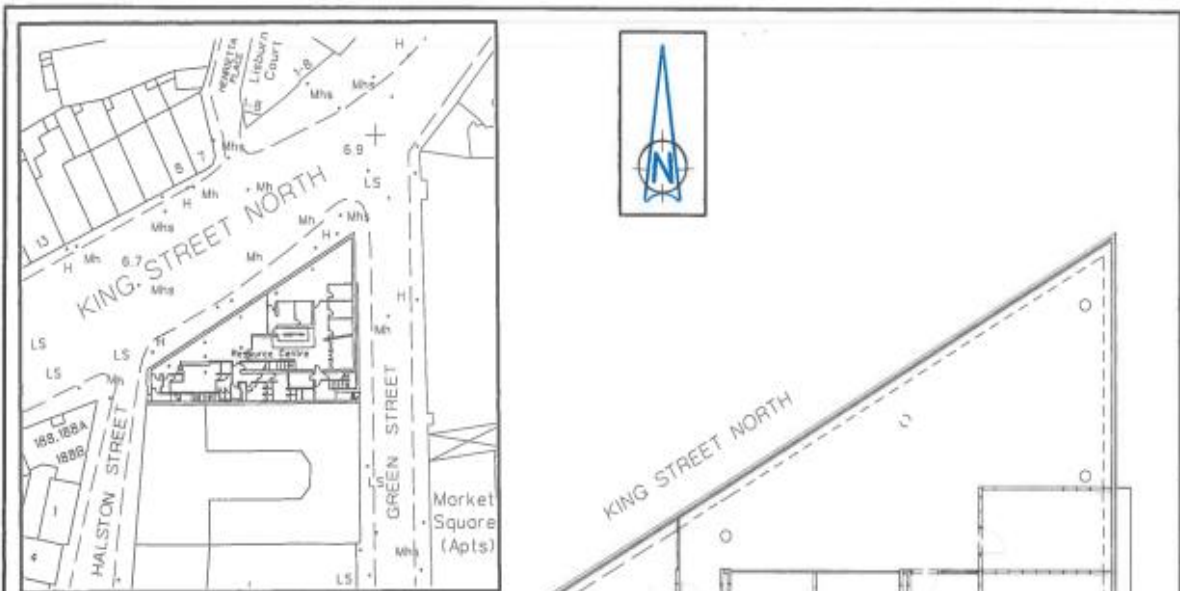

LOCATION MAP SCALE 1:1000

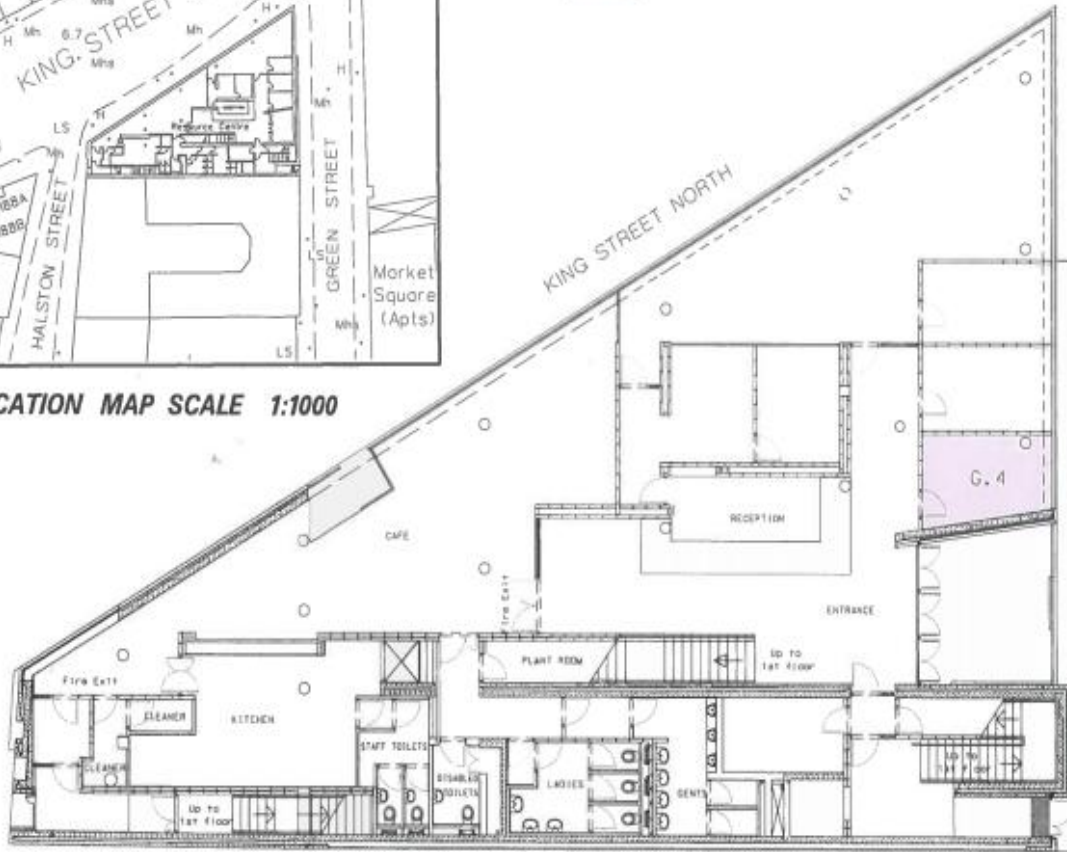

GROUND FLOOR PLAN (SCALE 1:200)

HALSTON STREET /NORTH KING STREET /GREEN STREET - MACRO BUILDING
Rooms G.4 (AREA: 11.4 sq m)
Dublin City Council to Georges Hill School & Community Employment
DISPOSAL OF LICENCE

DUBLIN CITY COUNCIL
Comhairle Cathrach Bhaile Átha Cliath
ENVIRONMENT AND ENGINEERING DEPARTMENT
An Roinn Comhshaoil agus Innealtóireachta
SURVEY AND MAPPING SERVICES DIVISION
Rannán Seirbhísi Suirbhéireachta agus Léarscailithe

O.S REF 3263-04, 3263-05	SCALE 1:1000 / 1:200
DATE 15.02.2013	SURVEYED / PRODUCED BY TJC

INDEX No	FOLDER No	CODE	DWG No	REV
FILE NO SM-2010-0367-0204-C3-002-A.dgn				

FOR PROPERTY REGISTRATION AUTHORITY PURPOSES ONLY
 THIS MAP IS CERTIFIED TO BE COMPUTER GENERATED BY
 DUBLIN CITY COUNCIL FROM ORDNANCE SURVEY DIGITAL MAPPING

MICHAEL PHILLIPS
CITY ENGINEER

SIGNED _____
PATRICK SHINE
 MANAGER LAND SURVEYING & MAPPING
 DUBLIN CITY COUNCIL

INDEX No.
SM-2010-0367-002

OSi data : © Ordnance Survey Ireland. All rig ts reserved. Licence Number 2010 /22CCMA/Dublin Cit/ Council

16/12/2016

To the Chairperson and Members of
The Central Area Committee

**With reference to the disposal of a plot of land to the rear of 1 Orchard Road,
Drumcondra, Dublin 3 to Mary Cass as LPR of Patrick Cass (deceased).**

An application has been received from Mary Cass as LPR of Patrick Cass (deceased) to purchase a plot of ground to the rear of her property at No. 1 Orchard Road, Drumcondra, Dublin 3. The plot of ground in question, which is shown coloured pink on Map Index No. SM-2016-0175 has been incorporated into her rear garden for many years.

It is proposed to dispose of the City Council's interest in the plot of ground to the rear of her property at No. 1 Orchard Road, Drumcondra, Dublin 3 to Mary Cass as LPR of Patrick Cass (deceased) subject to the following terms and conditions:

1. The consideration shall be in the sum of €3,000 (one thousand euro).
2. The land to be disposed of is with full freehold title and vacant possession.
3. The subject land is not encumbered by any services.
4. The purchaser shall pay Valuers' fees of €800 plus VAT.
5. The purchaser shall be responsible for both their own and the Council's legal costs in the matter.

The disposal shall be subject to any such covenants and conditions as the Law Agent in his discretion shall stipulate.

No agreement enforceable at law is created or intended to be created until an exchange of contracts has taken place.

Paul Clegg
Executive Manager

20/12/2016
Date



ORCHARD ROAD - Premises No. 1
Lands at rear
 Dublin City Council to Mary Cass as LPR of Patrick Cass (deceased)
 Lands in Dublin City Council ownership
 Area: 10m²

 Comhairle Cathrach Bhaile Átha Cliath Dublin City Council	<p>An Roinn Comhshaoil agus Iompair Rannán Suirbhéireachta agus Léarscáilithe Environment and Transportation Department Survey and Mapping Division</p>
--	--

O.S REF 3198-17	SCALE 1:1000
DATE 16-12-2016	SURVEYED / PRODUCED BY T. Curran

FILE NO	INDEX No	FOLDER No	CODE	DWG No	REV
SM-2016-0175_0204-C3-001-B.dgn					

THIS MAP IS CERTIFIED TO BE COMPUTER GENERATED BY
 DUBLIN CITY COUNCIL FROM ORDNANCE SURVEY DIGITAL MAPBASE
 SURVEY, MAPPING AND RELATED RESEARCH APPROVED

JOHN W. FLANAGAN
 PhD CEng Eur Ing FIEI FICE
ACTING CITY ENGINEER

APPROVED _____
THOMAS CURRAN
 ACTING MANAGER LAND SURVEYING & MAPPING
 DUBLIN CITY COUNCIL

INDEX No.

SM-2016-0175

OSI data : © Ordnance Survey Ireland. All rights reserved. Licence Number 2016 /23/CCMA/ Dublin City Council

Central Area Office
51/53 Sean McDermott Street
Dublin 1

3rd January, 2017

To the Chairperson and Members of
The Central Area Committee.

With reference to a Naming and Numbering Proposal for a Development at 49a-51
Arbour Hill, Dublin 7

This is a residential development on a site at 49a-51 Arbour Hill, Dublin 7, which will consist of 25 houses.

The developer has requested that the development be named “**Dawson Place/Plás Dásan**”.

The Heritage Officer considers the proposed name appropriate. This is based on Dawson Yard which is recorded in the area in the Griffith Land Report from the early 1900s and it is for this reason that the name “**Dawson Place/Plás Dásan**” is being proposed.

The houses will be numbered;

51 Arbour Hill, Dublin 7
65, 67 and 69 Montpelier Hill, Dublin 7
1-21 Dawson Place

The name “**Dawson Place/Plás Dásan**” is considered suitable and is recommended for adoption.

Rose Kenny
Executive Manager
Central Area

Central Jan 17 Area Agenda 10/01/17 (TAG Date: 20/12/16)											
Item	Request	Ref	Road	Post-code	Topic	Request Description	Request by	TAG Result	TAG Comments	Sec	Date Rec'd
1	Parking Prohibitions	34324	ARBOUR TERRACE (C-EA)	D7	Double Yellow Lines	at the entrance to the road.	cllr	Recommended	<p>Currently, it is Dublin City Council's policy to not introduce parking restrictions where restrictions are already covered under the law, such as placing Double Yellow Lines (DYLs) on a corner, as this would lead to a proliferation of same and additional expense due to maintenance, etc.</p> <p>"Under the Road Traffic Act it is illegal to block an entrance, park within 5m of a junction, park opposite a continuous white line or park on a public footpath."</p> <p>However, following a site inspection it was observed that there was increased difficulty for residents to access their properties due to the narrow entranceway to Arbour Terrace. Therefore, it is recommended that DYLs are installed on special grounds as follows:</p> <p>Install DYLs on the southern corner of the Arbour Terrace / St. Bricin's Park junction, in a westerly direction along Arbour Terrace for a distance of approx 10 m, and in a southerly direction along Arbour Hill for a distance of 5 m.</p>	0	07/10/2016
2	Admin	33234	ARRAN QUAY (C-EA)	D7	Bus Stop Marking	at Dublin Bus Stop No. 7453.	dublin bus	Recommended	<p>It is recommended to install a bus cage adjacent to Bus Stop no. 7453 on Arran Quay.</p> <p>It is not recommended to install a Broken Edge Cycle Line because a 25 m bus cage is sufficient to safely allow parallel docking in this location.</p> <p>Stat(s): Rescind Cycle Track Edge Line (RRM 022) on the Northern side of Arran Quay from LS No. 29, westwards for 25m.</p> <p>Install a Bus Cage (RRM 030) on the Northern side of Arran Quay from LS No. 29, westwards for 25m.</p>	0	28/07/2016

3	Parking Prohibitions	34720	BERKELEY AVENUE (C-EA)	D7	Double Yellow Lines	double yellow lines on both sides of Berkeley Ave and No Parking Signs erected.	resident	Recommended	<p>It is recommended to install Double Yellow Lines on Berkeley Avenue on both sides of the laneway for the following reason(s):</p> <ol style="list-style-type: none"> 1. Vehicles were parking in the laneway which is only 4.3 m in width (Greater than 4.6 m is required to allow for one-sided parking). <p>It is not recommended to install a No Parking Sign on Berkeley Avenue as the installation of DYLS provides an adequate indication that parking is not permitted at this location.</p> <p>Stat(s):</p> <ol style="list-style-type: none"> 1. Rescind the existing DYLS (stat no. 20539) on Berkeley Avenue. 2. Rescind the existing DYLS (stat no. 11314) on Berkeley Avenue. 3. Install DYLS on Berkeley Avenue, from the southern corner of the Berkeley Street / Berkeley Avenue junction in a north-easterly direction (around the perimeter of the laneway), for a distance of approx. 78 m. 4. Install DYLS on Berkeley Street, from the southern corner of the Berkeley Street / Berkeley Avenue junction in a southerly direction for a distance of approx. 5 m. 5. Install DYLS on Berkeley Avenue, from the northern corner of the Berkeley Street / Berkeley Avenue junction in a north-easterly direction (around the perimeter of the laneway), for a distance of approx. 103 m. 6. Install DYLS on Berkeley Street, from the northern corner of the Berkeley Street / Berkeley Avenue junction in a northerly direction 	1	25/10/2016
4	Parking Prohibitions	28618	CHURCH ROAD (C-EA)	D3	Double Yellow Lines	at the junction of Killan Road.	resident	Recommended	<p>It is recommended to rescind Double Yellow Lines on the Southern side of Church Road from a point 15m east of LS no. 19, westwards for approx. 75m.</p> <p>It is not recommended to install Double Yellow Lines at the junction of Church Road / Killane Road for the following reason(s):</p> <p><i>Parking restrictions such as the placing of double yellow lines are not recommended where restrictions are already covered under the law. Under the Road Traffic Act it is illegal to block an entrance, park within 5m of a junction, park opposite a continuous white line or park on a public footpath.</i></p> <p>Illegal parking should be reported to Dublin Street Parking Services Ph. 01 6022500 or to the Gardaí as they occur.</p> <p>Stat:</p> <p>Rescind DYLS on the Southern side of Church Road from a point 15m east of LS no. 19, westwards for approx. 75m.</p>	0	18/12/2015
5	Parking Prohibitions	31677	CHURCH STREET EAST (C-EA)	D3	Double Yellow Lines	at the junction of East Road.	resident	Not Recommended	<p>It is not recommended to extend the Double Yellow Lines (DYLS) on the East side of Irvine Court from the existing DYLS at the junction of Irvine Court / Church Street East for the following reason(s):</p> <ul style="list-style-type: none"> • DYLS are intended to ensure the smooth flow of traffic and to prevent hazards and prevent congestion where parking causes congestion which would interfere with traffic flows on a daily basis. No hazards or congestion problems were observed. • The road width was measured to be approx. 7m which is sufficient to allow double parking without seriously affecting access or forward visibility. • It is illegal to park within 5m of a junction and the length of the existing DYLS at the corner of Irvine Court / Church Street East was measured to be approx. 8m. <p>However, if there is a consensus to have a residential Pay & Display & Permit scheme examined; this can be facilitated by the Roads & Traffic Department.</p> <p>It is not recommended to re-spray the DYLS at the junction of Irvine Court / Church Street East / East Wall Road because the DYLS were observed to be in satisfactory condition.</p> <p>It is not recommended to reinstate the Stop Line at Church Street East / East Wall Road because there is already an existing Stop Line which was observed to be in a satisfactory condition.</p> <p>It is not recommended to extend the DYLS on the West side of Abercorn Road from the existing DYLS at the junction of Abercorn Road / Sheriff Street Upper for the following reason(s):</p> <ul style="list-style-type: none"> • It is illegal to park within 5m of a junction and the length of the existing DYLS at the corner of Abercorn Road / Sheriff Street was measured to be approx. 6.8 m. • Parking restrictions such as the placing of double yellow lines are not recommended where restrictions are already covered under the law. Under the Road Traffic Act it is illegal to park opposite a continuous white line. <p>Illegal parking should be reported to Dublin Street Parking Services Ph. 01 6022500 or to the Gardaí as they occur.</p>	0	11/05/2016
6	School Warden	28199	GRANGEGORMAN LOWER (C-EA)	D7	School Warden	request for School Warden/Beacons at Educate Together School.	resident	Not Recommended	<p>DCC does not erect beacons outside schools as some other Councils do. However we do erect school Warden and children crossing signs. School Warden warning signs or children will be erected when the present application for a School Warden has been determined by the Tag committee.</p>	2	01/12/2015

7	Parking Prohibitions	35531	JAMES JOYCE STREET (C-EA)	D1	Double Yellow Lines	on the street, remove pay and display	dcc planning	Recommended	Install Double Yellow Lines east side from junction with Talbot Street northwards for approximately 26 metres. Install 2 Pay and Display Parking Bays from approximately 26 metres north of the junction with Talbot Street towards Foley Street. Mon-Sat 07.00-19.00.	0	13/12/2016
8	Traffic Conditions	11531	KIRWAN STREET (C-EA)	D7	Yellow Box (Extend)	at its junction with Manor Street, also to serve the junction of Manor Street/Manor Place	cllr	Not Recommended	It is not recommended to extend the existing Yellow Box at the Manor Street / Kirwan Street junction to the Manor Street / Manor Place junction. This is due to the close proximity of the traffic lights near this junction which would leave inadequate space for a vehicle (other than one car) to stop at the lights, forcing the vehicle to stop over 20m away.	0	08/04/2014
9	Parking Prohibitions	28589	NORTH STRAND ROAD (C-EA)	D3	Cycle Track (Rescind)	on the footpath on North Strand Road at the junction of Aldborough Parade.	resident	Not Recommended	The inbound cycle lane in this area will be segregated from the footpath with the construction of the Clontarf to City Centre Cycle Scheme. This scheme is currently in the preliminary design phase and construction is tentatively planned for 2018. No further action recommended at this time.	0	10/12/2015
10	Traffic Signals	12065	PRUSSIA STREET (C-EA)	D7	Right Turn Filter Light	From Prussia Street onto North Circular Road	cllr	Not Recommended	Not recommended - Right Turn Filter Light. Please note that Dublin City Council makes every effort to ensure that all road users are accommodated within the phasing and sequencing of traffic signals and management of traffic movements. The ITS section Dublin City Council has evaluated the junction at Prussia Street / North Circular Road and cannot, at this time, recommend the installation of a right turn filter from Prussia Street to North Circular Road. Hanlons Corner is an extremely busy junction on all approaches with limited road width available. In order to provide a right turn filter as requested signal timing would need to be removed from other approaches which would increase overall congestion and, most importantly, delay the many bus routes that operate via this junction. We will however continue to monitor traffic movements at this junction and, if necessary, consider what changes may be beneficial.	2	13/05/2014
11	Parking Prohibitions	31976	RUTLAND STREET LOWER (C-EA)	D1	Double Yellow Lines	at school	dcc area office	Recommended	It is recommended to extend the Double Yellow Lines (DYLs) beyond the vehicular entrance to Rutland Street School to ensure vehicles can access and exit the gateway as follows: Extension of Double Yellow Lines (DYLs) on the West side of Rutland Street Lower from the existing DYLs outside house no. 36 C-D, in a Northerly direction for a distance of approx. 8m.	0	14/06/2016

12	Traffic Conditions	30895	SAINT JOSEPH'S PARADE (C-EA)	D7	Double Yellow Lines	Yellow box or double yellow lines at exit gate of car park	resident	Recommended	<p>Double Yellow Lines (DYLs) are to be rescinded 4.7m westwards and Pay & Display & Permit Parking is to be shifted 4.7m eastwards to ensure that vehicles can access and exit the gateway at the rear of building no. 64 Eccles St.</p> <p>It is not recommended to install a yellow box at the rear of building no. 64 Eccles St. due to the following: Yellow boxes are intended to prevent blocking of junctions. Side road traffic flows should be significant and the side road should serve a minimum of fifty houses or be a major traffic generating facility. This guideline is in place to avoid a proliferation of yellow boxes in the city.</p> <p>Upon site inspection, the entrance in question does not fit these criteria and thus a yellow box is not recommended. It is not recommended to install new DYLs at the rear of building no. 64 Eccles St. as DYLs are already installed at this location.</p> <p>Stat as follows: 1. Rescind DYLs on the Northern side of St. Joseph's Parade from a point 14.1m east of the Gable End of house no. 17, westwards for 4.7m. 2. Rescind Pay & Display & Permit Parking on the Northern side of St. Joseph's Parade from a point 9.4m east of the Gable End of house no. 17, westwards for 4.7m. 3. Extend Pay & Display and Permit Parking on the Northern side of St. Joseph's Parade from a point 14.1m east of the Gable End of house no. 17, westwards for 4.7m.</p>	0	20/04/2016
13	Parking Prohibitions	17886	SEVILLE TERRACE (C-EA)	D1	Double Yellow Lines	on the road.	resident	Recommended	<p>It is recommended to install Double Yellow Lines (DYLs) on the corners of the North Strand Road / Seville Terrace junction and on the south side of Seville Terrace.</p> <p>Following a site inspection and it was found that:</p> <ul style="list-style-type: none"> • Vehicles were double parking on the roadway which is only 4.8 m (Avg.) in width (Greater than 6.5 m is required to allow for double parking). <p>Stat(s):</p> <ol style="list-style-type: none"> 1. Install DYLs on the south corner of the North Strand Road / Seville Terrace junction for a distance of 5 m in the southwest direction and approx. 67 m in the southeast direction to the rear corner of Jennings' Funeral Home. 2. Install DYLs on the north corner of North Strand Road / Seville Terrace junction for a distance of 5 m in the northeast and southeast directions respectively. 	0	28/04/2015

14	Parking Prohibitions	28549	WEST ROAD (C-EA)	D3	Double Yellow Lines	between Seaview Avenue and East Wall Road.	resident	Not Recommended	<p>Following a site inspection, it is not recommended to install Double Yellow Lines at the following locations:</p> <ol style="list-style-type: none"> 1. West Road (corners between Seaview Avenue and East Wall Road); 2. Ossory Road (corners between West Road and North Strand Road); 3. Church Road (corners between East Wall Road and East Wall Credit Union); <p>For the following reason(s):</p> <ol style="list-style-type: none"> 1. Under the Road Traffic Act it is illegal to block an entrance, park within 5m of a junction, park opposite a continuous white line or park on a public footpath. <p>Therefore, it is not recommended to introduce parking restrictions where restrictions are already covered under the law, such as placing Double Yellow Lines on corners, as this would lead to a proliferation of same and additional expense due to maintenance etc.</p> <p>Illegal parking should be reported to Dublin Street Parking Services Ph. 01 6022500 as they occur.</p>	0	14/12/2015
15	Parking Prohibitions	14959	Portland Street North	1	Pay & Display & Permit Parking	on the road.	resident	recommended	Accepted at ballot, hours Mon-Sat 07.00-19.00. 36 on register, 11 votes returned, 7 for, 1 against, 1 late, 2 not on register.		

Traffic Service Requests, Status Report at 15th December, 2016, Central Area Committee Meeting, 10th January, 2017.

Please note that to ensure continued efficient operation of the Sharepoint database system it has become necessary to archive all completed items up to and including 31/12/15. Therefore these items are not reflected in the Status Report.

Traffic Advisory Group (TAG) Service Request Statistics

	15/11/2016 Report	15/12/2016 Report
Total TAG Requests received from 01/01/16 to 15/12/16	208	235
Total TAG Requests completed from 01/01/16 to 15/12/16	77	90
No. Requests received since previous report (i.e. between 16/11/16 and 15/12/16).	14	17
Total Requests received and currently open on Sharepoint since 1 st January, 2013.	242	258

Breakdown of Requests currently open on Sharepoint

Stage 1	2	4
Stage 2	183	172
Stage 3	11	8
Stage 4	32	51
Stage 5	14	23

Non TAG Service Requests Statistics

Total Non- TAG Requests received since 2016	610	
.....of which Requests Completed	374	
Total Requests currently received and open on Sharepoint since 1 st January, 2013	351	

Traffic Advisory Group Status Reports

Explanation of Stages:

- Stage 1 - Set up file, Assignment to Engineer, etc
- Stage 2 - Assessment, Site surveys, review statutory orders, etc
- Stage 3 - Consultations, with Garda, Dublin Bus, Luas, NTA, Local residents / businesses, etc
- Stage 4 - Decision, TAG group, statutory orders, etc
- Stage 5 - Implementation, signs, lines, construction, signal changes, certifications, etc

Item No.	SR No.	Road	Postcode	Topic	Request Description	Date Received	SR Status
1	6001	STONEYPATTER (C-EA)	D7	Yellow Box	at the junction of Stoneybatter and Arbour Place.	24/01/2013	Stage 4
2	7737	MARY STREET (C-EA)	D1		requires additional pedestrian safety measures.	20/06/2013	Stage 4
3	8417	CHURCH STREET (C-EA)	D1	Right Turn Filter Light	from Church Street onto King Street North.	23/08/2013	Stage 4
4	10552	GARDINER PLACE (C-EA)	D1	Pedestrian Crossing	at the junction of Mountjoy Square West.	06/02/2014	Stage 4
5	11531	KIRWAN STREET (C-EA)	D7	Yellow Box (Extend)	at its junction with Manor Street, also to serve the junction of Manor Street/Manor Place	08/04/2014	Stage 4
6	12065	PRUSSIA STREET (C-EA)	D7	Right Turn Filter Light	From Prussia Street onto North Circular Road	13/05/2014	Stage 4
7	12066	CHURCH ROAD (C-EA)	D3	Traffic Calming	Request for measures to reduce speeds and levels of traffic	13/05/2014	Stage 2
8	13954	BELVIDERE COURT (C-EA)	D1	Double Yellow Lines (Rescind)	to remove double yellow lines.	10/09/2014	Stage 2
9	13956	BELVIDERE COURT (C-EA)	D1	Pay & Display Parking	Request for pay and display parking.	10/09/2014	Stage 2
10	14264	OSSORY ROAD (C-EA)	D3	Double Yellow Lines (Rescind)	on the south side of Crosbie's Yard Apartments.	23/09/2014	Stage 5
11	14408	MANOR STREET (C-EA)	D7	Yellow Box	at the junction of Manor Street and Manor Place.(extend existing yellow box on Manor Street at junction with Kirwan Street)	14/10/2014	Stage 2
12	14561	NORTH STRAND ROAD (C-EA)	D3	School Ahead Sign	Request for additional sign at St Columba's School.	07/10/2014	Stage 4
13	14678	SHERIFF STREET UPPER (C-EA)	D1	Zebra Crossing	near the junction of Castleforbes Road.	09/10/2014	Stage 2
14	14959	PORTLAND STREET NORTH (C-EA)	D1	Pay & Display & Permit Parking	on the road.	29/10/2014	Stage 4

15	15087	SHERIFF STREET UPPER (C-EA)	D1	Zebra Crossing	close to Castleforbes Road	11/11/2014	Stage 2
16	15088	CASTLEFORBES ROAD (C-EA)	D1	Zebra Crossing	at the junction of Sheriff Street Upper and Castleforbes Road	11/11/2014	Stage 2
17	15203	BERKELEY ROAD (C-EA)	D7	Loading Bay	outside "Selections" Newsagents, No.22A.	11/11/2014	Stage 2
18	15252	SAMUEL BECKETT BRIDGE (C-EA)	D2	Yield Sign	Cycle Lanes at Samuel Beckett Bridge need "Yield" signs.	13/11/2014	Stage 2
19	15826	BERESFORD PLACE (C-EA)	D1	Pedestrian Crossing	crossing from Gardiner Street Lower to Custom House.	05/12/2014	Stage 2
20	15855	CLONLIFFE ROAD (C-EA)	D3	Bus Cage Marking (Rescind)	rescind all bus cage markings on Clonliffe Road as bus stop poles have been removed re Dublin Bus.	15/12/2014	Stage 2
21	16016	ECCLES STREET (C-EA)	D7	Parking Prohibition	outside No. 57.	02/01/2015	Stage 2
22	16085	GARDINER STREET LOWER (C-EA)	D8	Advance Cycle Stop Line	Requesting advance stop box for cyclists	06/01/2015	Stage 5
23	16283	DENMARK STREET GREAT (C-EA)	D1	Bus Stop (General Query)	Bus stop for Denmark Street outside Barrys Hotel and The Belvedere Hotel	23/01/2015	Stage 2
24	16467	NORTH CIRCULAR ROAD (C-EA)	D1	No Right Turn	from North Circular Road onto Dorset Street Lower.	30/01/2015	Stage 2
25	16493	CLONLIFFE ROAD (C-EA)	D3	Intelligent Traffic Signals	request review of filter light from Clonliffe Road onto Jones's Road.	03/02/2015	Stage 5
26	16512	SAINT JOSEPH'S ROAD (C-EA)	D7	No Right Turn	From St. Joseph's Road onto Prussia Street, during morning peak.	04/02/2015	Stage 2
27	16671	ARRAN STREET EAST (C-EA)	D7	Road Markings	Introduce road markings for existing Pay & Display & Permit spaces on Arran St West.	10/02/2015	Stage 2
28	16759	NORTH STRAND ROAD (C-EA)	D3	Yellow Box	at the main entrance to The Strand apartments.	17/02/2015	Stage 2
29	16960	BOLTON STREET (C-EA)	D1	Pedestrian Crossing	At the junction of Bolton Street/Henrietta Street.	26/02/2015	Stage 4
30	17226	HARBOUR COURT (C-EA)	D1	Double Yellow Lines (Rescind)	on the laneway.	18/03/2015	Stage 2
31	17432	WELLINGTON STREET UPPER (C-EA)	D7	Traffic Calming	on the road.	07/04/2015	Stage 2
32	17500	BELVIDERE COURT (C-EA)	D1	Loading Bay	in vicinity of 12-12A (Offices of MTS Security)	01/04/2015	Stage 2

33	17517	TALBOT STREET (C-EA)	D1	Stop Sign	At junction with Marlborough Street.	13/04/2015	Stage 4
34	17634	PRUSSIA STREET (C-EA)	D8	Right Turn Filter Light	from prussia street onto the NCR	17/04/2015	Stage 4
35	17635	PRUSSIA STREET (C-EA)	D8	Traffic Light Sequencing	Requests for the traffic light sequencing to be examined at above junction.	17/04/2015	Stage 4
36	17699	EAST WALL ROAD (C-EA)	D3	Yellow Box	at junction of West Road.	14/04/2015	Stage 2
37	17847	GRENVILLE STREET (C-EA)	D1	3 Tonne Limit	on the road.	25/04/2015	Stage 2
38	17850	BALLYBOUGH ROAD (C-EA)	D3	No Right Turn	from Ballybough Road onto Clonmore Road during evening peak.	27/04/2015	Stage 2
39	17886	SEVILLE TERRACE (C-EA)	D1	Double Yellow Lines	on the road.	28/04/2015	Stage 4
40	17908	ARBOUR TERRACE (C-EA)	D7		request for safety review by visually impaired resident at top of Arbour Terrace.	29/04/2015	Stage 2
41	17933	CHURCH STREET NEW (C-EA)	D7	Coach Parking	To increase the maximum stay time restriction on the Coach Parking.	29/04/2015	Stage 2
42	17946	WESTERN WAY (C-EA)	D7	Pedestrian Crossing	Request for a pedestrian crossing to be installed on Western Way.	01/05/2015	Stage 2
43	18042	GREEN STREET (C-EA)	D7	Disabled Parking Bay (General)	at the Macro Community Resource Centre, No. 1. Pay and Display Parking will have to be rescinded.	07/05/2015	Stage 2
44	18043	BUCKINGHAM STREET UPPER (C-EA)	D1	Disabled Parking Bay (General)	at Unit 4 Killarney Court.	07/05/2015	Stage 2
45	18061	CLONLIFFE AVENUE (C-EA)	D3	Speed Ramps	on the road.	07/05/2015	Stage 2
46	18114	CLONLIFFE ROAD (C-EA)	D3	Parking Prohibition	at the junction of Orchard Road.	12/05/2015	Stage 2
47	18158	SAINT BENEDICT'S GARDENS (C-EA)	D7	Disabled Parking Bay (Rescind Residential)	opposite No. 29, on the north side of the road, near the junction of Synnott Row.	14/05/2015	Stage 2
48	18282	PARKGATE STREET (C-EA)	D8	Loading Bay	outside Nancy Hands Bar & Restaurant, No. 30-32, from 9am to 12noon.	21/05/2015	Stage 2

49	18475	COMMONS STREET (C-EA)	D1	Pay & Display & Permit Parking (Rescind)	on Commons Street.	03/06/2015	Stage 2
50	18492	SUSANVILLE ROAD (C-EA)	D3	Double Yellow Lines (Extend)	at the side of No. 150, Clonliffe Road.	04/06/2015	Stage 5
51	18571	QUEEN STREET (C-EA)	D7	Clearway (Amend Hours)	Amend the hours on the street	09/06/2015	Stage 2
52	18712	SAINT BRIGID'S AVENUE (C-EA)	D3	Disabled Parking Bay (Rescind Residential)	outside No. 9.	16/06/2015	Stage 5
53	18807	STONEYPATTER (C-EA)	D7	Pedestrian Crossing	Pedestrian crossing for junction of Stoneybatter, Brunswick St North & Arbour Hill.	22/06/2015	Stage 2
54	18860	BERKELEY STREET (C-EA)	D3	Double Yellow Lines	at Father McSweeney House on Berkeley Street and to the side of the building (beside No. 12/13 Berkeley Street)	23/06/2015	Stage 4
55	18950	QUARRY ROAD (C-EA)	D7	Pedestrian Crossing	Request for Pedestrian crossing on the road.	30/06/2015	Stage 2
56	18983	HOPE AVENUE (C-EA)	D3	Yellow Box	Request for yellow box at junction of Hope Road/East Wall Rd	02/07/2015	Stage 2
57	18984	FAITH AVENUE (C-EA)	D3	Yellow Box	Request for yellow box at junction of Faith Ave/Eastwall Rd	02/07/2015	Stage 2
58	18986	STONEYPATTER ROAD (C-EA)	D3	Yellow Box	at the junction of Stoney Road/East Wall Road.	02/07/2015	Stage 2
59	18993	ARKLOW STREET (C-EA)	D7	Pay & Display & Permit Parking	on the road.	02/07/2015	Stage 2
60	19094	COMMONS STREET (C-EA)	D1	Pay & Display & Permit Parking (Rescind)	on Commons Street.	09/07/2015	Stage 2
61	19183	GLENGARRIFF PARADE (C-EA)	D7	Children Crossing Sign	in Phibsborough area, particularly at junction of Glengarriff Parade & St. Ignatius Rd.	10/07/2015	Stage 2
62	19199	BRUNSWICK STREET NORTH (C-EA)	D7	Pedestrian Crossing	at the junction of Stoneybatter, crossing from Walsh's Pub to Centra.	16/07/2015	Stage 2
63	19231	O'DEVANEY GARDENS (C-EA)	D7	Double Yellow Lines	on the road.	20/07/2015	Stage 5
64	19331	CLINCHS COURT (C-EA)	D3	Parking Prohibition	at the rear of No. 41, North Strand Road.	23/07/2015	Stage 2

65	19387	MONTPELIER HILL (C-EA)	D7	Traffic Calming	concerns about speeding cars, request for ramps &/or signage	24/07/2015	Stage 2
66	19405	DISTILLERY ROAD (C-EA)	D3	Single Yellow Line (Rescind)	to be removed from Distillery Road.	27/07/2015	Stage 5
67	19420	CHARLES STREET GREAT (C-EA)	D1	Double Yellow Lines	Request for Double Yellow Lines at the bottom of Nth Great Charles St.	30/07/2015	Stage 4
68	19460	TOLKA ROAD (C-EA)	D3	Traffic Calming	on the road	20/07/2015	Stage 2
69	19510	ORIEL STREET LOWER (C-EA)	D1	Traffic Calming	on the roads.	05/08/2015	Stage 2
70	19511	ORIEL STREET LOWER (C-EA)	D1	Double Yellow Lines	on the road.	05/08/2015	Stage 2
71	19606	SEAN MAC DERMOTT STREET UPPER (C-EA)	D1	Yellow Box	at the junction of Cumberland Street North, going south.	12/08/2015	Stage 2
72	19662	AUSTINS COTTAGES (C-EA)	D3	Double Yellow Lines	on the entrance road.	13/08/2015	Stage 4
73	19682	AUGHRIM LANE (C-EA)	D7	Double Yellow Lines	on the road.	14/08/2015	Stage 4
74	19695	NORTH CIRCULAR ROAD (C-EA)	D7	Parking Prohibition	Parking prohibitions for 281 North Circular Road.	17/08/2015	Stage 2
75	19737	ARBOUR HILL (C-EA)	D7	One-Way System	Request for one way system at narrow Eastern end of Arbour Hill	20/08/2015	Stage 2
76	19991	SAINT BENEDICT'S GARDENS (C-EA)	D7	No Entry	Request for NO ENTRY R/Markings on Saint Benedict's Gardens at junction with North Circular Road.	04/09/2015	Stage 5
77	19993	GOLDSMITH STREET (C-EA)	D7	Speed Ramps	Request for ramps on above road	04/09/2015	Stage 2
78	20114	MOORE STREET (C-EA)	D1	One-Way System	To make Moore Street and O'Rahilly Parade one way from Parnell Street.	11/09/2015	Stage 2
79	20121	MONCK PLACE (C-EA)	D7	Speed Ramps	on the road.	11/09/2015	Stage 2
80	20156	PORTLAND PLACE (C-EA)	D1	Double Yellow Lines	along by the apartments	08/09/2015	Stage 4
81	20286	ARKLOW STREET (C-EA)	D7	Pay & Display & Permit Parking	on the road.	21/09/2015	Stage 2
82	20330	SHERIFF STREET LOWER (C-EA)	D2	Yellow Box	at turn from Sheriff street into Amiens st and taxi lines repainted	21/09/2015	Stage 2
83	20461	NORTH CIRCULAR ROAD (C-EA)	D7	Bus Stop Approvals	North Circular Rd Stop 812 can it be built out to allow buses access passengers kerbside.	29/09/2015	Stage 2

84	20462	MONTPELIER GARDENS (C-EA)	D8	Traffic Lights	For buses coming out from O Devaney Gardens turning right onto Infirmary Rd.	29/09/2015	Stage 2
85	20596	AUGHRIM LANE (C-EA)	D7	Double Yellow Lines (Extend)	Request to have double yellow lines extended to both sides of lane up to lamp standard No. 1.	06/10/2015	Stage 5
86	20598	DISTILLERY ROAD (C-EA)	D3	Yellow Box	Request for yellow box or double yellow lines at entrance to Richmond Road industrial estate on Distillery road	06/10/2015	Stage 5
87	20841	CHURCH ROAD (C-EA)	D3	Bus Cage Marking	No bus stop road markings at two locations on this road.	14/10/2015	Stage 2
88	20867	ORIEL STREET UPPER (C-EA)	D1	Double Yellow Lines	Near jct. with Sheriff Street Lower on CIE side of road.	19/10/2015	Stage 2
89	21060	GREEK STREET (C-EA)	D1	Electric Car Bay	Provision of Electric Only Vehicle Bays.	28/10/2015	Stage 2
90	21086	PORTLAND PLACE (C-EA)	D1	Pay & Display & Permit Parking	on the road.	25/10/2015	Stage 2
91	21098	PRUSSIA STREET (C-EA)	D7	Traffic Lights	at junction with St Joseph's Rd.	13/10/2015	Stage 2
92	21105	PRUSSIA STREET (C-EA)	D7	Right Turn Filter Light	on Prussia Street onto North Circular Road	13/10/2015	Stage 4
93	21111	SHERIFF STREET UPPER (C-EA)	D3	Double Yellow Lines	at the junction of Abercorn Road.	29/09/2015	Stage 2
94	27760	JERVIS STREET (C-EA)	D1	Loading Bay	outside The Zipyard shop.	11/11/2015	Stage 2
95	27786	CHURCH ROAD (C-EA)	D3	Yellow Box	at its junction with the gated lane opposite the entrance to the proposed Lidl store.	10/11/2015	Stage 2
96	27787	EAST WALL ROAD (C-EA)	D3	Yellow Box	at junction with West Road	10/11/2015	Stage 2
97	27788	PORTLAND PLACE (C-EA)	D1	Double Yellow Lines	along by the apartments	10/11/2015	Stage 4
98	28102	TEMPLE LANE NORTH (C-EA)	D1	Parking Prohibition	in the loading bay after 7pm.	25/11/2015	Stage 2
99	28196	GRANGEGORMAN LOWER (C-EA)	D7		request for traffic signs at Educate Together School.	01/12/2015	Stage 2
100	28198	GRANGEGORMAN LOWER (C-EA)	D7	Traffic Calming	at Educate Together School	01/12/2015	Stage 2
101	28199	GRANGEGORMAN LOWER (C-EA)	D7	School Warden	request for School Warden/Beacons at Educate Together School.	01/12/2015	Stage 4

102	28231	PHIBSBOROUGH ROAD (C-EA)	D7	Yellow Box	Outside No. 55.	01/12/2015	Stage 2
103	28239	AUGHRIM STREET (C-EA)	D7	Traffic Calming	at Aughrim Court	08/12/2015	Stage 2
104	28306	HALSTON STREET (C-EA)	D7	3.5 Tonne Limit	on Halston Street.	04/12/2015	Stage 2
105	28378	SHELMALIER ROAD (C-EA)	D3	Double Yellow Lines (Rescind)	outside No. 1.	07/12/2015	Stage 2
106	28482	PARKGATE STREET (C-EA)	D8	Stop Sign	and rescindment of Yield Sign on Parkgate Street at the junction of St. John's Road West.	10/12/2015	Stage 2
107	28531	SHERIFF STREET LOWER (C-EA)	D1	Traffic Calming	on the stretch from Noctors Pub to the Church.	15/12/2015	Stage 2
108	28549	WEST ROAD (C-EA)	D3	Double Yellow Lines	between Seaview Avenue and East Wall Road.	14/12/2015	Stage 4
109	28553	OSSORY ROAD (C-EA)	D3	Double Yellow Lines	between West Road and North Strand Road.	14/12/2015	Stage 4
110	28557	SWIFT'S ROW (C-EA)	D1	Loading Bay	on Swifts Row to facilitate the business premises at No. 21 Lower Ormond Quay.	17/12/2015	Stage 2
111	28562	SAINT JOSEPH'S ROAD (C-EA)	D7	Disabled Parking Bay (Residential)	outside No. 3 St. Joseph's Rd, Augrim Street. Pay and Display and Permit Parking will have to be rescinded.	16/06/2016	Stage 5
112	28589	NORTH STRAND ROAD (C-EA)	D3	Cycle Track (Rescind)	on the footpath on North Strand Road at the junction of Aldborough Parade.	10/12/2015	Stage 4
113	28615	RUSSELL AVENUE (C-EA)	D3	Pay & Display & Permit Parking	on the road.	22/12/2015	Stage 3
114	28618	CHURCH ROAD (C-EA)	D3	Double Yellow Lines	at the junction of Killan Road.	18/12/2015	Stage 4
115	28716	KINGS AVENUE (C-EA)	D3	Disabled Parking Bay (Rescind Residential)	outside No. 26.	08/01/2016	Stage 4
116	28738	NORTH CIRCULAR ROAD (C-EA)	D7	Double Yellow Lines (Extend)	in the vicinity of No. 281.	07/01/2016	Stage 2
117	28741	PARNELL STREET (C-EA)	D1	Yellow Box	or other safety measures at the junction of Hill Street.	07/01/2016	Stage 2
118	28849	WEST ROAD (C-EA)	D3	Parking Prohibition	along the road.	13/01/2016	Stage 2

119	28872	ORIEL STREET LOWER (C-EA)	D2	Speed Ramps	on the road.	13/01/2016	Stage 2
120	28873	NIALL STREET (C-EA)	D7	Double Yellow Lines (Rescind)	and installation of P&D&Permit Parking lines outside No.35	12/01/2016	Stage 2
121	28984	SAINT IGNATIUS ROAD (C-EA)	D7	Double Yellow Lines	on the whole length of the laneway to rear of property Nos. 1-52 (accessed between property Nos 23 and 24) to ensure access to businesses.	20/01/2016	Stage 5
122	29015	JERVIS STREET (C-EA)	D1	Loading Bay	in the vicinity of McDonalds.	18/01/2016	Stage 2
123	29021	NORTH STRAND ROAD (C-EA)	D3	Children Crossing Sign	at the pedestrian crossing outside St. Columbas School.	18/01/2016	Stage 4
124	29130	NORTH CIRCULAR ROAD (C-EA)	D7	Pay & Display & Permit Parking	from the laneway at No. 45 to No. 93 (the junction with Marlborough Road).	18/01/2016	Stage 2
125	29131	SEAVIEW AVENUE (C-EA)	D3	Parking Prohibition	outside No. 75, Seaview Avenue, East Wall.	25/01/2016	Stage 2
126	29150	SUSANVILLE ROAD (C-EA)	D3	Yellow Box	at junction of Clonliffe Road.	25/01/2016	Stage 2
127	29198	NORTH CIRCULAR ROAD (C-EA)	D7	Pay & Display & Permit Parking	from the laneway at No. 45 to No. 93 (the junction with Marlborough Road).	27/01/2016	Stage 2
128	29262	SEVILLE PLACE (C-EA)	D1	Yellow Box	Requesting yellow box be installed at the junction of Coburg Place & Seville Place	02/02/2016	Stage 2
129	29275	PARNELL SQUARE NORTH (C-EA)	D1	Bus Cage Marking	Change the Coach markings to read "bus" at Parnell Square North	01/02/2016	Stage 2
130	29357	RUTLAND STREET LOWER (C-EA)	D1	Disabled Parking Bay (General)	outside the old Rutland Street School.	03/02/2016	Stage 2
131	29411	CLONLIFFE ROAD (C-EA)	D9	3.5 Tonne Limit	Request for HGV restrictions on above road	06/02/2016	Stage 2
132	29539	NORTH STRAND ROAD (C-EA)	D3	School Ahead Sign	at the entrance to St. Columbas School.	18/01/2016	Stage 4
133	29658	MONTPELIER HILL (C-EA)	D7	Speed Ramps (Rescind)	at narrow section of Montpelier Hill	09/02/2016	Stage 2
134	29659	WEST ROAD (C-EA)	D3	Parking Prohibition	on the road.	09/02/2016	Stage 2

135	29815	ARRAN QUAY (C-EA)	D7	Road Markings	EXCEPT BUSES paint marking requested after the left turn arrow at bus stop at Quill pub on Arran Quay	19/02/2016	Stage 5
136	29856	WOLFE TONE STREET (C-EA)	D1	Zebra Crossing	at junction of Wolfe Tone Street / Mary Street.	22/02/2016	Stage 2
137	29920	NORTH CIRCULAR ROAD (C-EA)	D1	Clearway (Amend Hours)	extend clearway hours to 07.00-19.00 .	25/02/2016	Stage 2
138	30042	EAST WALL ROAD (C-EA)	D3	Pedestrian Crossing	at the junction of East Wall Road and Alfie Byrne Road.	01/03/2016	Stage 4
139	30094	CHURCH ROAD (C-EA)	D3	Traffic Calming	on the road.	04/03/2016	Stage 2
140	30127	ELIZABETH STREET (C-EA)	D3	Pay & Display & Permit Parking	on the road.	07/03/2016	Stage 2
141	30239	KILLARNEY PARADE (C-EA)	D7	Double Yellow Lines (Extend)	and rescindment of Pay and Display and Permit Parking from the junction of Muckcross Parade to the junction of North Circular Road.	11/03/2016	Stage 2
142	30284	CUMBERLAND STREET NORTH (C-EA)	D1	Pedestrian Crossing	at Avondale House.	14/03/2016	Stage 2
143	30402	KINGS INNS STREET (C-EA)	D7	Loading Bay	Loading bay outside microbrewery and visitor centre in Parnell centre	22/03/2016	Stage 2
144	30431	MONTPELIER HILL (C-EA)	D7	Speed Ramps (Rescind)	and provision of alternative traffic calming measures between Nos. 52 and 41.	23/03/2016	Stage 2
145	30498	CHURCH ROAD (C-EA)	D3	Double Yellow Lines (Rescind)	from No. 44 upwards.	24/03/2016	Stage 2
146	30515	AVONDALE AVENUE (C-EA)	D7	Disabled Parking Bay (Residential)	To determine if Avondale Avenue is high/low demand in relation to parking occupancy regarding the provision of a bay outside No. 4.	30/03/2016	Stage 4
147	30587	CUMBERLAND STREET NORTH (C-EA)	D1	Pedestrian Crossing	at Avondale House.	04/04/2016	Stage 2
148	30614	PORTLAND PLACE (C-EA)	D1	Double Yellow Lines (Extend)	from the playground to the bollards at Sherrard Court, on the apartments side of the road.	06/04/2016	Stage 4

149	30659	PARKGATE STREET (C-EA)	D8	Traffic Calming	On Parkgate Street at the junction of St. John's Road West.	08/04/2016	Stage 2
150	30725	CUMBERLAND STREET NORTH (C-EA)	D1	Pedestrian Crossing	at Avondale House.	13/04/2016	Stage 2
151	30797	GRANBY PLACE (C-EA)	D1	Double Yellow Lines (Rescind)	In relation to the rescindment of Double Yellow Lines outside No. 43.	14/04/2016	Stage 2
152	30806	CAPEL STREET (C-EA)	D1	Disabled Parking Bay (General)	and rescindment of Pay and Display Parking at the Medical Centre, No. 138.	14/04/2016	Stage 2
153	30873	FITZROY AVENUE (C-EA)	D3	Pay & Display & Permit Parking	on the road.	23/03/2016	Stage 3
154	30895	SAINT JOSEPH'S PARADE (C-EA)	D7	Double Yellow Lines	Yellow box or double yellow lines at exit gate of car park	20/04/2016	Stage 4
155	30935	MOUNTJOY SQUARE EAST (C-EA)	D1	Traffic Calming	at the junction of Fitzgibbon Street and Belvedere Place.	21/04/2016	Stage 2
156	30960	CHURCH ROAD (C-EA)	D3	Double Yellow Lines (Extend)	Extension of dyl's on Church Road, on both sides of the road, from East Wall Road junction.	22/04/2016	Stage 5
157	31026	JONES'S ROAD (C-EA)	D3	Filter Light	for exiting Holycross College onto Clonliffe Road and Jones Road	26/04/2016	Stage 2
158	31027	HENRIETTA STREET (C-EA)	D1	Disabled Parking Bay (General)	and rescindment of Pay and Display and Permit Parking outside the Daughters of Charity.	26/04/2016	Stage 2
159	31070	RATHDOWN ROAD (C-EA)	D7	3.5 Tonne Limit	on the road.	27/04/2016	Stage 2
160	31071	GRANGEGORMAN LOWER (C-EA)	D7	3.5 Tonne Limit	on the road.	27/04/2016	Stage 2
161	31099	CHURCH ROAD (C-EA)	D3	Disabled Parking Bay (General)	Outside Eastwall Health Centre.	28/04/2016	Stage 4
162	31132	EDEN QUAY (C-EA)	D1	Pedestrian Crossing	on the east side of the junction of Marlborough Street.	29/04/2016	Stage 2
163	31215	AVONDALE AVENUE (C-EA)	D7	Stop Sign	for Allen Tce and the Burrow which lead onto Phibsborough.	09/05/2016	Stage 2
164	31282	RATHDOWN ROAD (C-EA)	D17	Speed Ramps	Additional speed bump between 60 & 70 Rathdown Rd.	10/05/2016	Stage 2

165	31322	CATHAL BRUGHA STREET (C-EA)	D1	Disabled Parking Bay (General)	Request for general bays opposite the Catering College, DIT.	03/05/2016	Stage 2
166	31323	SHERIFF STREET UPPER (C-EA)	D1	Double Yellow Lines	From PLS No.7, easterly for 15 metres, Northside of Carriageway.	12/05/2016	Stage 5
167	31335	ORIEL STREET UPPER (C-EA)	D1	Speed Ramps	above junction	13/05/2016	Stage 2
168	31360	FITZROY AVENUE (C-EA)	D3	Pay & Display & Permit Parking	on the road.	13/05/2016	Stage 3
169	31384	DORSET STREET LOWER (C-EA)	D1	Double Yellow Lines (Extend)	at rear of number 13-15	17/05/2016	Stage 2
170	31392	FINGAL PLACE (C-EA)	D7	Pay & Display & Permit Parking (extension of area)	Review 6 uncontrolled parking bays	17/05/2016	Stage 5
171	31486	FITZROY AVENUE (C-EA)	D3	Pay & Display & Permit Parking	on the road.	20/05/2016	Stage 3
172	31540	TALBOT STREET (C-EA)	D1	Bus Cage Marking	At no.31 Bus Terminus (needs to be painted in red)	24/05/2016	Stage 2
173	31597	DORSET STREET UPPER (C-EA)	D1	Yellow Box	at the junction of Frederick Lane North.	26/05/2016	Stage 2
174	31677	CHURCH STREET EAST (C-EA)	D3	Double Yellow Lines	at the junction of East Road.	11/05/2016	Stage 4
175	31901	PARNELL STREET (C-EA)	D1	Traffic Management Arrangements	at rear of Ilac - extend and improve Footpath to facilitate cyclists and pedestrians.	10/05/2016	Stage 2
176	31902	CUMBERLAND STREET NORTH (C-EA)	D1	Traffic Calming	Traffic calming in form of Pedestrian Crossing or road narrowing.	10/06/2016	Stage 2
177	31903	MANOR STREET (C-EA)	D7	Yellow Box (Extend)	at the junction of Manor Street and Manor Place.(extend existing yellow box on Manor Street at junction with Kirwan Street)	10/05/2016	Stage 2
178	31909	CLONLIFFE ROAD (C-EA)	D3	3.5 Tonne Limit	requesting update on the request.	14/06/2016	Stage 2
179	31976	RUTLAND STREET LOWER (C-EA)	D1	Double Yellow Lines	at school	14/06/2016	Stage 4

180	32021	PARNELL SQUARE WEST (C-EA)	D1	Double Yellow Lines (Extend)	to extend by 10 metres or more northwards the existing DYL's outside approx No.36	07/06/2016	Stage 2
181	32131	BLESSINGTON LANE (C-EA)	D7	Double Yellow Lines	on above lane	21/06/2016	Stage 2
182	32222	ARRAN QUAY (C-EA)	D7	Cycle Track	request for a non-mandatory cycle lane (broken line) between Arran Street West and Lincoln Lane at Dublin Bus Stop No. 7453 to allow buses access the stop.	22/06/2016	Stage 5
183	32293	CHARLEVILLE AVENUE (C-EA)	D3	Traffic Calming	One of the following: additional children crossign sign; 20kph speed limit; GO SLOW painted on the road surface.	23/06/2016	Stage 2
184	32307	CHARLEVILLE AVENUE (C-EA)	D3	Traffic Calming	Extra traffic calming measures on the road.	23/06/2016	Stage 2
185	32341	PARNELL SQUARE WEST (C-EA)	D1	Double Yellow Lines (Extend)	to extend by 10 metres or more northwards the existing DYL's outside approx No.36	27/06/2016	Stage 2
186	32353	CHARLEVILLE AVENUE (C-EA)	D3	Children Crossing Sign	on the gable wall of Mr Kebab.	27/06/2016	Stage 2
187	32361	CHARLEVILLE AVENUE (C-EA)	D3	Traffic Calming	A Slow sign or a children crossign sign.	28/06/2016	Stage 2
188	32851	PARNELL SQUARE WEST (C-EA)	D1	Double Yellow Lines	rescindment of this Bus stop and replacement with DYLs.	20/07/2016	Stage 2
189	32871	RUSSELL STREET (C-EA)	D1	Pay & Display & Permit Parking	along the boundary of St. Patrick's Terrace , from house No. 1 to 17 inclusive.	20/07/2016	Stage 3
190	32972	CHURCH ROAD (C-EA)	D3	Yellow Box	at entrance to Lighthouse Apartments	27/07/2016	Stage 2
191	33079	JOSEPHINE AVENUE (C-EA)	D7	Pay & Display & Permit Parking (change of hours)	For extension of operational hours.	02/08/2016	Stage 3
192	33109	LEO AVENUE (C-EA)	D7	Pay & Display & Permit Parking (change of hours)	For extension of operational hours.	02/08/2016	Stage 3

193	33110	LEO STREET (C-EA)	D7	Pay & Display & Permit Parking (change of hours)	For extension of operational hours.	02/08/2016	Stage 3
194	33114	CHURCH ROAD (C-EA)	D3	Yellow Box	At entrance to Lighthouse Apartments.	02/08/2016	Stage 2
195	33119	OXMANTOWN ROAD (C-EA)	D7	Disabled Parking Bay (Residential)	outside No. 173. Pay and Display and Permit Parking will have to be rescinded.	03/08/2016	Stage 4
196	33130	FITZROY AVENUE (C-EA)	D3	Disabled Parking Bay (Residential)	outside No. 66.	05/08/2016	Stage 5
197	33137	PORTLAND ROW (C-EA)	D1	Disabled Parking Bay (Rescind Residential)	Outside No. 19.	03/08/2016	Stage 4
198	33152	MARY'S LANE (C-EA)	D7	Loading Bay (Extend)	Extend recently installed loading bay	05/08/2016	Stage 2
199	33166	ARBOUR HILL (C-EA)	D7	Parking Permitted	2 hours max parking sign requested	18/07/2016	Stage 4
200	33234	ARRAN QUAY (C-EA)	D7	Bus Stop Marking	at Dublin Bus Stop No. 7453.	28/07/2016	Stage 4
201	33326	EAST WALL ROAD (C-EA)	D3	Yellow Box	entrance/exit from Aldi	18/08/2016	Stage 2
202	33432	MONCK PLACE (C-EA)	D7	Disabled Parking Bay (Residential)	outside No. 28.	29/08/2016	Stage 2
203	33447	CALEDON ROAD (C-EA)	D3	Disabled Parking Bay (Residential)	outside No. 37.	30/08/2016	Stage 2
204	33473	OXMANTOWN ROAD (C-EA)	D7	Disabled Parking Bay (Residential)	outside No. 159. Pay and Display and Permit Parking will have to be rescinded.	30/08/2016	Stage 2
205	33480	DORSET STREET LOWER (C-EA)	D1	Right Turn Filter Light	Right turn filter light when turning on to Synnott Place from Dorset Street.	13/10/2016	Stage 2
206	33618	AMIENS STREET (C-EA)	D1	Bus Lane (Removal)	Rescind the last 30m of inbound bus lane just before the railway bridge.	01/09/2016	Stage 2
207	33630	NORTH STRAND ROAD (C-EA)	D3	Yellow Box	at the main entrance to The Strand apartments.	06/09/2016	Stage 2
208	33668	FOLEY STREET (C-EA)	D1	Disabled Parking Bay (General)	request for two disabled parking bays	08/09/2016	Stage 2
209	33700	HALSTON STREET (C-EA)	D7	Stop Sign	Request for a stop sign to be re-located nearer the junction.	12/09/2016	Stage 2

210	33780	NORTH WALL QUAY (C-EA)	D1	Disabled Parking Bay (Rescind General)	Request to re-locate the disabled bay away from the EV point and install Electric Car Charge bay.	14/09/2016	Stage 2
211	33813	CHURCH STREET EAST (C-EA)	D3	Disabled Parking Bay (Rescind Residential)	outside No. 11.	13/09/2016	Stage 5
212	33837	ROSEMOUNT ROAD (C-EA)	D7	Traffic Calming	on the road.	14/09/2016	Stage 2
213	33878	KILLARNEY STREET (C-EA)	D1	Disabled Parking Bay (Residential)	To determine if Killarney Street is high/low demand in relation to parking occupancy for the provision of a bay outside No. 22. Pay and Display and Permit Parking will have to be rescinded.	15/09/2016	Stage 2
214	33922	NORTH CIRCULAR ROAD (C-EA)	D7	Yellow Box	Into the IPS building at the junction of North Circular Road with Berkeley Road.	20/09/2016	Stage 2
215	33974	ECCLES STREET (C-EA)	D7	Bus Cage Marking (Rescind)	and provision of pay and display and permit parking or disabled parking bays in the vicinity of No. 56/57.	22/09/2016	Stage 2
216	33983	BACHELORS WALK (C-EA)	D1	Loading Bay	and rescindment of bus cage marking at Nos. 5-9.	20/09/2016	Stage 2
217	34050	GREEN STREET (C-EA)	D7	Disabled Parking Bay (General)	Two general disabled parking bays at the entrance to the Irish Human Rights and Equality Commission, No. 16-22. Pay and display parking will have to be rescinded.	23/09/2016	Stage 2
218	34105	GARDINER STREET LOWER (C-EA)	D1	Bus Stop Signpost		08/08/2016	Stage 4
219	34115	GRANGEGORMAN LOWER (C-EA)	D7	School Warden	at the junction of Fitzwilliam Place North for Dublin 7 Educate Together National School.	03/10/2016	Stage 4

220	34216	SAINT MARY'S ROAD NORTH (C-EA)	D3	Disabled Parking Bay (Residential)	outside No. 44.	11/10/2016	Stage 2
221	34224	RUSSELL STREET (C-EA)	D1	Loading Bay	outside Plumb Merchants Ltd., No.10b, 40, Russell Street.	29/09/2016	Stage 2
222	34242	WESTERN WAY (C-EA)	D7	Disabled Parking Bay (General)	Two bays to the east of the entrance to the Romanian Orthodox Church of the Annunciation.	30/09/2016	Stage 2
223	34324	ARBOUR TERRACE (C-EA)	D7	Double Yellow Lines	at the entrance to the road.	07/10/2016	Stage 4
224	34372	GRENVILLE LANE (C-EA)	D1	Double Yellow Lines	Request for DYL on opposite side of lane.	11/10/2016	Stage 2
225	34498	RUTLAND PLACE (C-EA)	D1	Double Yellow Lines	rear of 11 Parnell Sq East. Either side of shutters - building adjacent to PO depot	14/10/2016	Stage 2
226	34565	CLONLIFFE ROAD (C-EA)	D3	Parking Prohibition	at junction with St Joseph's Avenue	17/10/2016	Stage 2
227	34602	KILLARNEY STREET (C-EA)	D1	Disabled Parking Bay (General)	Request for additional general bay at Killarney Court. Pay and Display and Permit Parking will have to be rescinded.	18/10/2016	Stage 2
228	34633	SHERIFF STREET UPPER (C-EA)	D1	7.5T Max Gross Weight (Traffic Mgt)	between the junction with East Road and Seville Place.	25/10/2016	Stage 4
229	34682	SAINT MARY'S ROAD NORTH (C-EA)	D1	Double Yellow Lines	at both junctions with Church Road.	25/10/2016	Stage 5
230	34685	EAST ROAD (C-EA)	D3	Double Yellow Lines	on all corners	25/10/2016	Stage 5
231	34687	EAST ROAD (C-EA)	D3	Bus Stop Marking	on East Road at Dublin Bus Stop outside GK Hire.	25/10/2016	Stage 5
232	34688	SHELMALIER ROAD (C-EA)	D3	Double Yellow Lines	on Shelmalier Road from the Church Road junction (East Wall Road end).	25/10/2016	Stage 5
233	34693	RAVENSDALE ROAD (C-EA)	D3	Entry Treatment	at the junction of Ravensdale Road and Shelmalier Road.	27/10/2016	Stage 4
234	34694	O'CONNELL STREET UPPER (C-EA)	D1	No Right Turn	for northbound traffic onto Cathal Brugha Street (eastbound).	26/10/2016	Stage 4

235	34720	BERKELEY AVENUE (C-EA)	D7	Double Yellow Lines	double yellow lines on both sides of Berkeley Ave and No Parking Signs erected.	25/10/2016	Stage 4
236	34725	BERKELEY AVENUE (C-EA)	D1	Double Yellow Lines	Request for DYL on both sides of Berkeley Avenue due to parked cars blocking access for emergency vehicles and blocking rear entrances to properties on nelson st.	26/10/2016	Stage 4
237	34764	DORSET STREET LOWER (C-EA)	D7	Filter Light	Filter light on Dorset St Lwr, for turning right onto Eccles St./ North Ciruclar Road/Synott Place	27/10/2016	Stage 2
238	34834	MAY STREET (C-EA)	D3	Double Yellow Lines	outside No 6 May Street, from the end of the p&d pay to the junction.	04/11/2016	Stage 4
239	34845	FOLEY STREET (C-EA)	D1	Loading Bay(Rescind)	Request locations of loading bay and nearby P&D parking be swapped	07/11/2016	Stage 2
240	34973	HENRIETTA STREET (C-EA)	D1	Disabled Parking Bay (General)	and rescindment of pay and display parking at the junction of Henrietta Place.	10/11/2016	Stage 2
241	35018	SAINT JOSEPH'S ROAD (C-EA)	D7	Speed Ramps	Speed ramps for St. Joseph's Rd.	11/11/2016	Stage 2
242	35020	KILLARNEY AVENUE (C-EA)	D1	Double Yellow Lines	outside the garage entrance no.24	10/11/2016	Stage 2
243	35033	DORSET STREET LOWER (C-EA)	D1	Right Turn Filter Light	From Dorset Street Lower onto Synnott Place.	11/11/2016	Stage 2
244	35104	SAINT IGNATIUS ROAD (C-EA)	D7	Double Yellow Lines	appeal for extension of previously recommended dyl's to the rear of property Nos. 1-52.	14/11/2016	Stage 2
245	35117	LINENHALL PARADE (C-EA)	D7	Double Yellow Lines (Rescind)	outside 25	17/11/2016	Stage 2
246	35150	DORSET STREET LOWER (C-EA)	D1	Right Turn Filter Light	request for Right Turn Filter Light from Dorset Street Lower onto Synnott Place be reviewed.	16/11/2016	Stage 2

247	35152	NORTH STRAND ROAD (C-EA)	D3	Pedestrian Crossing	across Ossory Road at North Strand Road junction and across North Strand Road north of the junction with Ossory Road.	18/11/2016	Stage 4
248	35155	SUSANVILLE ROAD (C-EA)	D3	Pay & Display & Permit Parking	on the road.	16/11/2016	Stage 2
249	35170	RUSSELL AVENUE (C-EA)	D3	Disabled Parking Bay (Residential)	outside No.35	21/11/2016	Stage 2
250	35184	SUSANVILLE ROAD (C-EA)	D3	Pay & Display & Permit Parking	on the road.	18/11/2016	Stage 2
251	35291	EAST ROAD (C-EA)	D1	Yellow Box	request from developer to install yellow box at entrance to An Post Depot site to prevent build up of HGVs trying to access site.	28/11/2016	Stage 2
252	35356	NORTH CIRCULAR ROAD (C-EA)	D7	Filter Light	request for filter lights at Hanlon's Corner from Old Cabra Road and Prussia Street onto North Circular Road.	02/12/2016	Stage 4
253	35362	NORTH WALL QUAY (C-EA)	D1	Yellow Box	requests yellow box at above junction	05/12/2016	Stage 1
254	35425	DORSET STREET LOWER (C-EA)	D1	Filter Light	Filter traffic light for junction of Dorset St Lwr & Synnott Place.	08/12/2016	Stage 2
255	35426	DORSET STREET UPPER (C-EA)	D1	Yellow Box (Extend)	Double size of yellow box at Dorset St Upper & Wellington St Lwr.	08/12/2016	Stage 1
256	35427	DORSET STREET LOWER (C-EA)	D1	Right Turn Filter Light	for traffic turning right from NCR onto Dorset St Lwr.	08/12/2016	Stage 1
257	35428	DORSET STREET UPPER (C-EA)	D1	Filter Light	Filter lights for entire junction.	08/12/2016	Stage 1
258	35531	JAMES JOYCE STREET (C-EA)	D1	Double Yellow Lines	on the street, remove pay and display	13/12/2016	Stage 4

To the Chairperson and Members of
the Central Area Committee

January, 2017

Environmental Services Unit Report

Litter Warden Statistics

There were a total of **8** Fines issued by the area based Litter Wardens in the Central Area for littering offences in the period 1st December 2016 – 31th December 2016

109 Streets were inspected

305 Dumped bags were removed

313 Dumped bags were investigated

98 Dumped or wrongly presented bags were labelled with warning stickers

Quarterly Comparison

Month	Streets Inspected	Bags removed	Bags Investigated	Bags Stickered	Fines Issued
September	174	338	324	134	41
October	179	445	459	24	24
November	164	464	572	61	15
December	109	305	313	98	8

Litter Hotline/CRM

In the period 1st December – 31th December 2016, 175 incidents were reported via Litter Hotline/CRM.

Incidents - Central Area Office

Group Name	Sr Type	Count of Incidents
Central Area Office	Community Cleanups	11 
	Footpath Issues	1 
	Illegal Dumping	154 
	Overflowing Skips	1 
	Remove Hazarduous Waste	1 
	Report Graffiti	3 
	Report Litter Offence	4 
Grand Total		175

Graffiti Removal

Graffiti has been removed from the following areas using our Corporate Contractor from 1st December 2016 – 31th December 2016

Amien Street, D.1
Rosie Hackett Bridge, D.1
Phibsborough Road, D.7

Graffiti has been removed from the following areas using our Waste Management Services from 1st December 2016 – 31th December 2016

Sean Macdermott Street Lower, D.1
North Lotts, D.1
Belvidere Road, D.1
Great Strand Street, D.1
Sheriff Street Lower, D.1
Ossory Road, D.3
Newcomen Avenue, D.3
Johnny Cullens Hill, D.3
Clonliffe Road, D.3
NCR, D.7
Mountjoy Parade, D.7
Saint Josephs Parade, D.7
Geraldine Street, D.7
Auburn Street, D.7
Ellis Quay, D.7
Henrietta Place, D.7
Smithfield Plaza, D.7
Phibsborough Road, D.7

Graffiti has been removed from the following areas using the Probation Services Services from 1st December 2016 – 31th December 2016

Hardwicke Lane, D.1
Parnell Street, D.1
Empress Place, D.1
Portland Row, D.1
New Wapping Street, D.1
Mayor Street Upper, D.1
Sheriff Street Upper, D.1
Healy Street, D.1
East Wall Road, D.3
Spingarden Street, D.3
Ennaville Avenue, D.3
Binns Bridge, D.9
Royal Canal Bank, D.9

Pop up Park Church Street Brunswick Street Junction

The finalized DCC owned vacant site recently improved and opened up under the direction of Mark Jones Parks Department. It is a great improvement not only to Church Street but to central area on the whole.

Below are the images from start to finish.



N.I.C.L.A.G. – Road Sweeping – Clonliffe Avenue

In early January 2017 Central Area Public Domain Team in conjunction with the Waste Management have organised a road sweeper to clean Clonliffe Avenue. We have requested residents to park on the right hand side of the street 10th January 2017 for a number of hours so that the sweeper could access the kerbs and road along the left hand side of the street. Then alternate to the other side the following day the 11th January 2017. Signage was erected along the street and every house was leafleted in advance to ensure residents were informed.

Please also find included a copy of the notice posted to local residents.



Dublin City Council
Comhairle Cathrach Bhaile Átha Cliath

Príomhoifig an Lárcheantair, An Lárcheantar,
51-53 Sráid Sheáin Mhic Dhíarmada Iocht, Baile Átha Cliath 1

Central Area Headquarters, Central Area,
51-53 Sean McDermott Street Lower, Dublin 1
T. 01 2222248 F. 01 2223831 E. central.area@dublincity.ie

December 2016

Notice Road Sweeping - Clonliffe Avenue

Dear Resident,

Dublin City Council is requesting that you park your motor vehicle (if applicable) on the **right hand** of **Clonliffe Avenue** (when entering from the Ballybough Road –please see below location map) on **Tuesday 10th January 2017 from 9.30am – 1pm**.

Also please park your motor vehicle (if applicable) on the **left hand** of **Clonliffe Avenue** (when entering from the Ballybough Road –please see below location map) on **Wednesday 11th January 2017 from 9.30am – 1pm**.

This is to facilitate the Road Sweeper to sweep the left hand side of the street properly



Thanking you in advance for your co-operation in this matter.

Yours sincerely,
Robert Ingram

Robert Ingram
Environmental liaison Officer Central Area

CCTV

As part of central areas anti-dumping CCTV initiative, Public Domain Unit have identified more black spots in central area. Continued installation of CCTV has proven a success in dumping blackspot areas.

New locations identified December:

- Merchants Road East Wall
- Bella Street
- Gaelic Street Ossary Road

REMINDER OF DUBLIN CITY COUNCIL WASTE MANAGEMENT SERVICES CHRISTMAS / NEW YEAR ARRANGEMENTS 2016/2017

Dublin City Council are pleased to announce that the following Bring Centres will also open on **Sunday 8th 15th 22nd January only** from **12pm - 4pm** to facilitate the recycling of Christmas trees and additional Christmas packaging:

- Oscar Traynor Road, Coolock, Collins Avenue, Dublin 11
- Collins Avenue, Dublin 9 (opposite DCU entrance)
- Windmill Road, Crumlin, Dublin 12
- Gulistan Terrace, Rathmines, Dublin 6
- Grangegorman, Upper Grangegorman Road, Dublin 7

Christmas trees will be accepted free of charge from the 3rd to 22nd January 2017 at the following locations

Dublin Central Area

Croke Park, Cusack Stand (via St. Joseph's Ave.)	Wed 4th to Fri 6th Jan: 8am - 8pm Sat 7th to Sun 8th Jan: 10am – 4pm Mon 9th to Fri 13th Jan: 8am – 8pm Sat 14th to Sun 15th Jan: 10am– 4pm (Refer to www.croke.park.ie)
Grangegorman, Upper Grangegorman Road, Dublin 7	Opening hrs Mon to Thurs 9am – 4pm Fri 9am – 1pm Sat 10am – 4pm Sun (8th 15th 22nd January only) 12pm– 4pm

Dublin City Council would like to thank everyone for their recycling efforts during the year. Let's make 2017 the best year yet for recycling!

John McPartlan

Public Domain Enforcement Officer

**To the Chairperson and Members of
the Central Area Committee**

January, 2017

Central Area Housing Report

(1) Chris Butler, Area Housing Manger

Vacant site, Railway Street

Circle Voluntary Housing Association have now finalised a proposed design and made a presentation to Councillors on Thursday 10th November. DCC have since met residents from the Kiln and Forge to discuss the proposal and they have expressed support for the project. Circle VHA made a presentation to their residents in Peadar Kearney House on the 9th of December. While many residents were positive some objected strongly on the basis that they wanted the site retained for community use and in particular a football pitch. Further meetings will be held in the New Year.

St. Mary's Mansions

Following a presentation to the residents and the Area Councillors which received a very positive response, a planning application was lodged on the 6th May 2016 for redevelopment of the complex. Final Grant Notice was issued on the 8th August and Cluid expect work to commence on site in April 2017. The redevelopment is due to be completed in December 2018.

Detenancing has continued but it was not possible to have the complex vacated by the end of the year. Approximately 8 tenants will remain in the complex until early 2017 and most of these have accepted offers and will move in January. DCC and Cluid continue to work to residents who have not yet been facilitated but some residents have now changed their housing requirements and are being somewhat excessive in their demands for rehousing. All tenants have been or will be made reasonable offers of temporary alternative accommodation but should they continue to be intransigent they may jeopardise the viability of the project.

Entrances to the stairwells on K block have been secured s all residents on the upper floors have now moved out.

Gloucester Place/Former IDA site

Construction work commenced in late February following some delays with the issuing of fire certs. As part of the initial works the site has been hoarded off along with the adjacent smaller site which the same developer has agreed to purchase. Plans for the adjacent site will be submitted shortly. Site clearance works are also underway and the project is progressing well.

Prior to commencement of works a meeting was held on the 26th January between local Housing staff, residents reps, school reps and Bennetts Construction to outline the project and discuss issues such as traffic and noise management. A further meeting has since taken place and issues around traffic management and window cleaning were raised. Residents in Gloucester Place also staged a protest, blocking the road, but following a meeting between the builder and these residents no further protests have taken place. As most of the issues raised by residents were not directly related to matters that DCC could address it has been decided that DCC will no longer participate in this meetings. The meetings have continued between the contractor and residents and residents can raise any planning or other relevant issues directly with DCC.

Some issues in relation to working hours and illegal parking have been raised by residents recently. These matters have been referred to Parking Enforcement and Planning Enforcement for investigation.

Castelforbes

The 26 units at Castleforbes (Northbank), that DCC are acquiring, are not completed and are now in the hands of the receiver. Dublin City Council is currently engaging with the receiver regarding the acquisition of the Part V units in the development. Due to the nature of the works to be undertaken it now extremely unlikely that these units will be acquired before the beginning of 2017.

Tuath Housing have now agreed contracts to acquire 21 units in Castleforbes Square. Sales were due to close on these units in early October but there has been a delay and it now unlikely units will be occupied until early in the New Year. 11 of the units will initially be used to temporarily house residents from Gallery Quay to facilitate remedial works in relation to water ingress and insulation. The remaining 10 units (8x 2 bed, 2 x 1 bed) will be allocated to applicants from DCC's Housing, Transfer and Priority lists. Selection of applicant has taken place and names of nominees have been forwarded to Tuath Housing for interview.

Avondale House

Following ongoing issues with the security doors in the complex, along with concerns the residents had raised after the violent incident earlier in the year, it was decided to replace the doors with a stronger and more durable door. The new doors were installed in December.

Apartment blocks Sheriff Street

The stairwells and common areas in the apartment blocks at Mariners Port, Crinan Strand and Spencer Dock have fallen in to a poor condition over recent years. We have recently installed new, more secure post boxes and now intend to replace the main entrance doors and the floor covering and to paint the stairwells. These works have now commenced and should be completed by early 2017.

(2) Brian Kavanagh, Area Housing Manager

Poplar Row, Taaffe Place, Annesley Avenue & Place – Pyrite Issues

The Pyrite remediation works were carried out in three 10/12 week phases. All 3 phases have been completed with the exception of some snagging works and all of the tenants having returned to their homes. The work will be inspected before the end of the defects period and any defects attributable to the works will be rectified. These inspections will be carried out on the 12th and 13th December. A service along with an inspection of the gas boilers has been carried out.

Croke Villas

There are 8 dwellings out of 79 currently occupied in Croke Villas 1 of which are currently in the process of moving to alternative accommodation.

Works are continuing on Block 3 to facilitate consolidating the remaining residents from blocks 1, 2 and 4 into the one block and these moves will be completed by early January 2017 pending the completion of the homes at 2-6 Ballybough Road.

The Project Estate Officer for Croke Villas continues to liaise with An Garda Siochana in relation to drug users congregating on some of the stairwells in this complex.

The Part 8 report in relation to the demolition of all four blocks was approved at the October meeting of the City Council.

The Main Tender for the development of the units on 2-6 Ballybough Road has been assessed by Dublin City Council and is with the Department of Housing & Community seeking their approval to proceed with the award of contract to the successful tenderer.

City Architects have appointed the design team for the overall project and preparation of a Part 8 for the cottages on Sackville Ave, housing units on the site of the Croke Villas flat blocks and the roadway has commenced.

Ballybough House

The Housing Manager and Community Worker met with residents in November to discuss ongoing maintenance and anti-social issues. Significant works are now taking place to improve the complex.

New lighting is being installed and the entire courtyard has been power washed. Repairs have been carried out on four of the six stairwells and the remaining stairwells will be repaired after Christmas, provided arrangements can be made to maintain access while the works are being done. New, replacement, bins have also been provided.

To address the ongoing problem of youth's congregating on the stairwells it is proposed to install security doors at the entrance to the stairwells. This work is expected to commence in early January. The Project Estate Officer is continually liaising with An Garda Síochána to identify the individuals causing problems in the complex and to take whatever action is required to resolve this problem.

Repair works to the playgrounds will be completed in January and some landscaping works will be done in the Courtyard. Some painting works will also be carried out.

We are currently examining the potential to knock 2 flats into 1 and create larger living spaces within the units. As we may require tenants to move temporarily within the complex none of the current vacant units will be let for the moment.

Delays have occurred to the completion of the CCTV system but works should be completed shortly.

The Area Housing Manager, the Project Estate Officer and the Community Development Officer continue to meet with Residents and good progress has been made with residents working with the Area Office to bring about improvements at the complex.

Vacant Site at Poplar Row

Oaklee Housing lodged a planning application ref: 4124/15 on 30th November 2015 for a development of 29 units of accommodation (4 no. 2 beds and 25 no. 1 beds) at Poplar Row (formally Block 2). Planning permission with conditions was granted to Oaklee Housing on 10th June 2016 however an appeal was lodged with An Bord Pleanála by the local Residents Association. A meeting with Area Councillors, Oaklee Housing Trust and representatives from the adjacent residents was held on the 5th July 2016 in relation to their concerns with an agreement to provide additional information as to the effect the proposed building will have on the light to adjoining homes. An agreement was also reached to ensure improved communications by forming a liaison group with DCC, Oaklee and Resident representatives when the development commences. Oaklee Housing Trust were advised on Friday 30th Sept 2016 of a notice to grant planning by ABP for Poplar Row. Work on the detailed design has commenced and site surveys are currently being carried out by Oaklee's Design team.

Tom Clarke House

Work commenced on site on the 2/11/2015 converting bedsits into one bedroom apartments. The Contractor is D&S Higgins Construction Ltd. Work on the first phase is completed and the units are allocated, work on phase 2 has commenced with completion anticipated end of Quarter 1 2017.

St. Agatha's Court

The Peter McVerry Trust was asked by Dublin City Council to bring forward proposals for the site at St. Agatha's Court. The proposal put forward is to convert 16 units into 8 larger units and construct 4 additional units giving a total of 11 units. The units have been vacant for some time so it would bring them back into use. The Department of Environment Community and Local Government in May granted approval in principle to the construction of the 11 units at a cost of €1,170,000 with a view to starting on site in 2015.

Work commenced on site in April 2016 and completion is scheduled for January 2017.

Disposal of the site (by lease) to the Peter McVerry Trust was approved at the March meeting of the City Council. The Peter McVerry Trust are liaising with Housing Allocations/ Homeless Services in relation to allocating the completed units.

(3)Sean Smith, Area Housing Manager

Dominick Street Lower

The part 8 proceedings for 5-3 bed town houses, 68 apartments consisting of 5-3 bed, 50-2 bed and 12-1 bed units, a community facility and retail/commercial units with 47 car spaces at basement level on the eastern side of Dominick Street.

Ongoing meetings will take place with the Dominick Street Lower Redevelopment group and our design team during the months of January, February and March.

Luas Cross City Works

Residents of Constitution Hill, Dominick St Lower, Dominick House, Dominick Court and Dominick St Upper have been kept updated on the progress of the Luas Cross City (LCC). LCC staff and the Contractor (SSJV) have discussed the programme of works with local residents. Contractor is currently on-site in Constitution Hill, Dominick Street Lower/Upper, Mountjoy St, Dorset Street/Bolton Street and Parnell Street.

Work is ongoing on the road reconstruction of the traffic lane of Dominick Street Lower. January will see the commencement of the road reconstruction of the traffic lane on Dominick Street Lower near the entrance to Dominick Place.

TRAFFIC FLOW

- The access from Parnell Square West and Granby Place onto Dominick Street Lower will be closed during the works. The current traffic flows on Parnell Street and Dominick Street Lower remain unchanged during these works.
- Please note that vehicles can access Granby Place as normal via Parnell Square West. Vehicles can exit Granby Place via Granby Lane towards Granby Row to reach Dorset Street.
- There is no impact on the pedestrian access to Granby Place during these works.

It is anticipated that works will take place between the 13th and 27th January, subject to site conditions and weather conditions.

- Broadstone – Constitution Hill
Works continue off street on the Broadstone plaza levelling works and at the Grangegorman stop.
- Dominick Street Lower
The traffic lane between Parnell Street and Bolton Street will be reconstructed in a phase approach. Dominick Place will be closed off to allow the road reconstruction to be completed. Local traffic will get to Granby Place via Parnell Square West and exit via Granby Lane onto Granby Row only. On completion of the road works, the crews will move into footpath works on the side of the Lower Dominick Street flats.
- Dominick Street Upper – Between Constitution Hill and Mountjoy Street. The works on the paving started during week commencing 12th December 2016, on the side of Temple Cottages. These works will continue during January and February 2017. The traffic flow stays the same. No impact on pedestrian movements. The last tracks are getting completed at Cumiskey's pub during January. The hardscaping and landscaping in that general area near Western Way will continue over the coming months.

- Dominick Street Upper – Between Constitution Hill and Bolton Street. Hardscaping in the general area near the Bolton Street Junction will take place during December 2016.

Various milestones were achieved in the City Centre and in the off street section of the works. With the last on street tracks brought to site and due for completion in the coming weeks, the focus of the works will switch to the close out of the road works, the paving of footpaths and platforms and installation of power and systems during 2017.

SSJV would like to thank everyone for the collaboration they gave the project throughout 2016. It is anticipated that the Luas Cross City will be operational by the end of 2017.

Sisk Steconfer JV (SSJV) crews will endeavour to reduce the impact of the works to a minimum. However, if you need to get in touch with us during these works, you will be able to reach SSJV's site representative on 01/5397979.

Constitution Hill

Ongoing meetings with Residents are taking place. Luas Cross City Staff, the Housing Manager and Project Estate Officer are keeping Residents up-to-date on the proposed plans/works for Broadstone Gate.

Dorset Street & Saint Marys Terrace

Ongoing meetings are taking place with Residents, Estate Management and the Gardai in relation to antisocial behaviour in Dorset Street and Saint Marys Place complex.

Henrietta House

Painting of the stairwells in both blocks commenced in December, works are ongoing.

Blackhall Place/Marmion Court

An extensive painting programme for the Blackhall/Marmion complex is ongoing.

Saint Michans House

Works on the speed restriction ramps in Blocks C,D,E,F. will commence in January.

C.C.T.V

A contractor is currently on site in Dominick Street Upper, Constitution Hill, Dorset Street and Kevin Barry House, doing necessary repair works to the defective cameras in these complexes.

Christmas Events

All four community centres held their annual Christmas dinner for the Senior Citizens in the NWIC area, and was a great success. Santa Claus visited the centres for the children's Christmas parties and numerous Christmas events and outings were organised for the children in the NWIC area.

The Following Complexes have regular meetings between residents and Estate Management and there are no outstanding issues.

- Henrietta House
- Dominick Court
- Dominick House/Palmerston Place
- Dominick Street Upper
- Eccles Court
- Saint Peters Court
- Kevin Barry House

- Sheridan Place/Court
- Hardwicke Street
- North King Street
- Haymarket/Queen Street
- Dorset Street

(4) Dick Whelan, Area Housing Manager

St. Bricins Park

Works on Block 3 (Phase 2 to the refurbishment) are continuing and fortnightly on site meetings are being held which will closely monitor progress. As previously stated the scheduled completion date for Phase two is mid 2017.

O'Devaney Gardens

A detailed report on redevelopment proposals for the site was presented to the December meeting of Housing SPC and hard copies of that document have been circulated to remaining residents. There have been no further transfers out of the last two blocks and, as was the case last month, there are still 6 occupied flats.

Drumalee Estate

The MUGA has been reopened for limited use by the public and it is hoped to have it fully open early in the New Year. Works on the courtyard area of Drumalee Court (Prussia Street side) have made a significant difference to the appearance of the complex and it is expected that these works will be completed in the next couple of months.

Karl Mitchell

Assistant Area Manager

To the Chairperson and Members of
the Central Area Committee

North East Inner City Ministerial Task Force

In early November 2016 Dublin City Council was notified by the Department of Housing, Planning, Community & Local Government that scope had been identified in the Department's regeneration funding commitments for 2016 to re-allocate up to €3M to Dublin City Council, under the NEIC Initiative, for the purposes of further regeneration works and upgrade of community facilities. The Department of HPC&LG requested a submission setting out proposed projects for funding under this allocation. It was emphasised that in order to secure the funding it must be drawn down in 2016.

A submission was prepared in consultation with relevant front line Dublin City Council services and final approval was received from the Department on 6th December 2016 for a total allocation of €2.655M in respect of the following projects.

Housing	Ballybough House, Courtney Place and surrounding areas – upgrade and improvement works e.g. lighting, deep cleaning, security systems, landscaping, resurfacing etc.	€750,000
Public Lighting	Painting of lampposts and upgrade of existing public lighting, replacement with LED including Ballybough Rd., North Strand Rd., Amiens St., Summerhill Parade.	€250,000
Public domain improvements	Hoarding and façade improvements of various sites in derelict or unsightly condition including corner of Russell St. / NCR, ESB site Sean Mac Dermott St.	€20,000
	Further road re-surfacing and street improvements to complement works approved under Round 1 funding i.e. Railway St. (section from James Joyce St. to Buckingham St.); James Joyce St. (section from Foley St. to Sean MacDermott St.); Sean Mac Dermott St. (Marlborough St. to Buckingham St.); Cumberland St. North, Beaver St.	€745,000
	Mountjoy Square Park improvement works including restoration of railings.	€300,000
Refurbishment / maintenance/ upgrade of community facilities	Dorset St. Fire Station (Community Use); Lourdes Daycare Centre; Lourdes Parish Hall; NEC Community Garden; Sean MacDermott St. Swimming Pool (internal works); The LAB City Arts Office; Sheriff St. Recreation Centre; Ballybough Community Youth & Fitness Centre; Sophia Housing Association.	€590,000
TOTAL:		€2,655,000

As specified by the Department of Housing, Planning, Community and Local Government Dublin City Council committed to delivering these projects within a short timeframe and works is progressing in this regard.

Mr. Kieran Mulvey presented a draft of his report to the Ministerial Task Force on 21st December 2016. It is understood that a draft will also be presented to local community representatives for feedback in the coming weeks with a view to submission of the final report to Government at end January 2017.

Ursula Donnellan
Administrative Officer

19th December, 2016

To the Chairperson and Members of
the Central Area Committee

GGDA Report – January 2017

A platform for a unique conversation between transition year students and artist-lecturers at D.I.T.

A new art project is set to enable young students in the Grangegorman area to engage creatively with two artists who lecture in DIT. This new project has been commissioned under Pathway 2 of ‘...the lives we live’, the Grangegorman public art programme. This pathway is aimed at supporting community based projects/events and opening up relationships between secondary and tertiary level students as well as with the wider local community. The Public Art Working Group is currently supporting eight community-based arts projects to support openness within institutions to explore and engage ambitious projects of lasting relevance.

The next deadline for submissions for Pathway 2 is Friday 25th January 2017. For full information on all of the pathways go to www.ggda.ie/public_art.

Central Area Age Friendly Report - January 2017

Summary of a Central Area Age Friendly meeting held with An Garda Siochana on the 7th December 2016

A meeting was held this month to discuss how to progress actions in the Central Area Older Person’s Strategy where the Gardai are a lead agency.

1. Encourage more policing within parks to enable older people to use and feel safe in them – Liberty Park / Blessington Basin

Action

- DCC will notify the Gardai of upcoming events in Liberty Park / Blessington Basin so that a police presence can be arranged.
2. (a) The Gardai to regularly attend events/activities at venues for older people to provide information and address safety concerns.

(b) Provide information/guidance for older people to protect themselves against bogus callers/tradesmen in the Central Area

Action

- DCC will supply list of older persons groups in the Central Area to the Gardai.
- DCC will liaise with local older person groups to identify suitable venues/events for Gardai to attend. DCC will give details of make-up of group, their concerns and topics they want covered.
- DCC will also consult locally to identify any vulnerable older people/locations which the Gardai can assist.
- The Gardai will liaise with their Community Liaison Gardai and Crime Prevention Unit in Harcourt Street to provide information and 'meet & greet' sessions for older people in the Central Area.
- The Gardai will be invited to give a presentation at the next Central Area Age Friendly Alliance meeting to link in with other agencies in providing support to vulnerable older people.

Brian O'Connell
Administrative Officer

Dublin City Sport & Wellbeing Partnership Report

- The 2017 **Lord Mayor's 5 Alive Challenge** kicked off on New Year's Day in the Phoenix Park with the Liffey Valley Tom Brennan Memorial 5K. The five race series is proving as popular as ever with the maximum 450 entrants signing up within an hour of registration opening. The challenge runs from January to April and more details can be found at: www.dublincity.ie/lord-mayor-5-alive-challenge-2017
- What: **Yoga**
Who: **HSE Mental Health Referrals**
Where: Ballybough Sports & Community Centre
Dates: 19th, 26th Jan & 2nd, 9th Feb
Time: 12-1pm
- What: **Chair Aerobics**
Who: **CRC-People with Physical and Intellectual Disabilities**
Where: Ballybough Sports & Community Centre
Date: 19th, 26th Jan & 2nd, 9th Feb
Time: 11-12pm
- What: **Mixed Circuit Fitness**
Who: **HSE Mental Health Referrals**
Where: Ballybough Sports & Community Centre
Date: 20th, 27th Jan & 3rd, 10th Feb
Time: 12-1pm
- What: **Walking Club**
Who: **Older Adults**
Where: Clonliffe Community Centre
Dates: 20th, 27th Jan & 3rd, 10th Feb
Time: 11am
- What: **Pulmonary Rehabilitation Class**
Who: **Referred Participants**
Where: Ballybough Sports & Community Centre
Date: 24th, 31st Jan & 7th Feb
Time: 2-4pm
- What: **Gaelic Gaels**
Who: **Girls 9-13 years**
Where: Sheriff Street Community Centre
Date: 19th, 26th Jan & 2nd, 9th Feb
Time: 4-5pm

- What: **Boccia**
Who: **St. Michael's House**
Where: Ballybough Sports & Community Centre
Date: 19th, 26th Jan & 9th Feb
Time: 11-12pm
- Our **Cricket** Development Officer will be liaising with Sports Officers in the area to co-ordinate programmes for the New Year.
- **Provincial cricket sessions** continue on Friday nights from 5pm – 9.30pm. These are held in the North County Cricket Club where a number of players from the Central Area are involved. Players are between 10-18 years of age.
- Currently organising days and times with schools in the area for **schoolyard cricket sessions** that will be starting in February. In particular, there will be a focus on schools that are entered in the Leprechaun Cup (Primary School's Cricket Competition).

Football

- Drop-in football is ongoing each Tuesday in Aughrim Street Sportshall from 3.30pm – 5pm for boys & girls aged between 9 and 12 years.
- A school coaching session is ongoing every Wednesday in Coláiste Eanna, Cabra, from 2pm – 4pm
- **Club Development:** The local Football Development Officer will facilitate a Child Welfare Course and a Kickstart 1/PDP1 Course in January (dates & venue tbc)

Contact details

Antonia Martin, DCSWP Manager: antonia.martin@dublincity.ie

Igor Khmil, Sports Officer: igor.khmil@dublincity.ie

Fergal Scally, Sports Officer: fergal.scally@dublincity.ie

Treacy Byrne, Ballybough Centre Manager: treacy.byrne@dublincity.ie

Ian Hill, Soccer: ian.hill@fai.ie

Tommy Carberry, Soccer: tommy.carberry@fai.ie

Paul Quinn, Boxing: paulquinn999@gmail.com

Fintan McAllister, Cricket: fintan.mcallister@cricketleinster.ie

Billy Phelan, Rugby: billy.phelan@leinsterrugby.ie

Stephen Maher, Rugby: stephen.maher@leinsterrugby.ie

Alan Morrin

Staff Officer

Dublin City Sport & Wellbeing Partnership

List of Motions
10th January, 2017

Motion in the name of Councillor Ciaran Cuffe

That this Committee requests the Sports and Fitness Centres to reduce the amount of the increase in the new monthly fee to €12

Motion in the name of Councillor Nial Ring

That this Committee agrees that the classes and public hours currently available at Sean McDermott Street swimming pool will not be reduced when the Markiewicz Pool reopens.

